

PVS12EDTL Personal Viewing System, Integrated Controller and Personal Entertainment Player Operation and Maintenance Guide

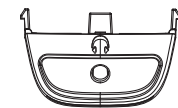
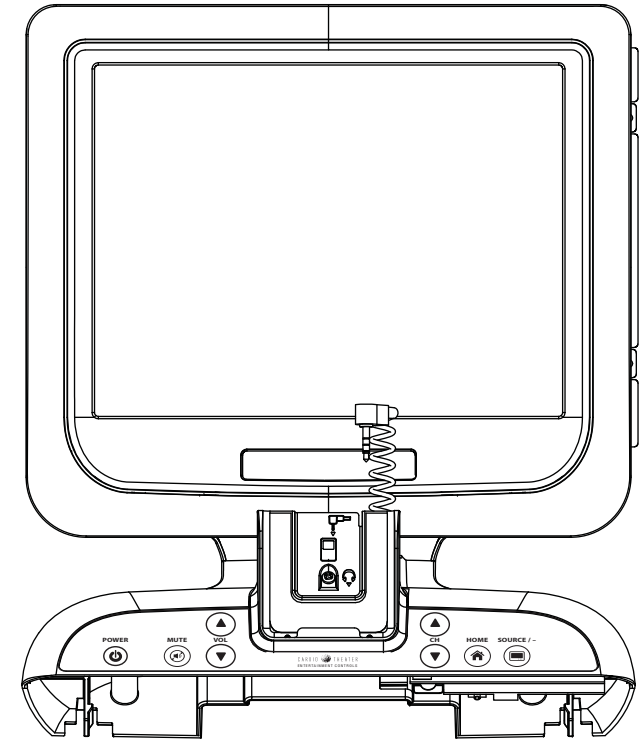
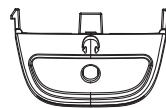
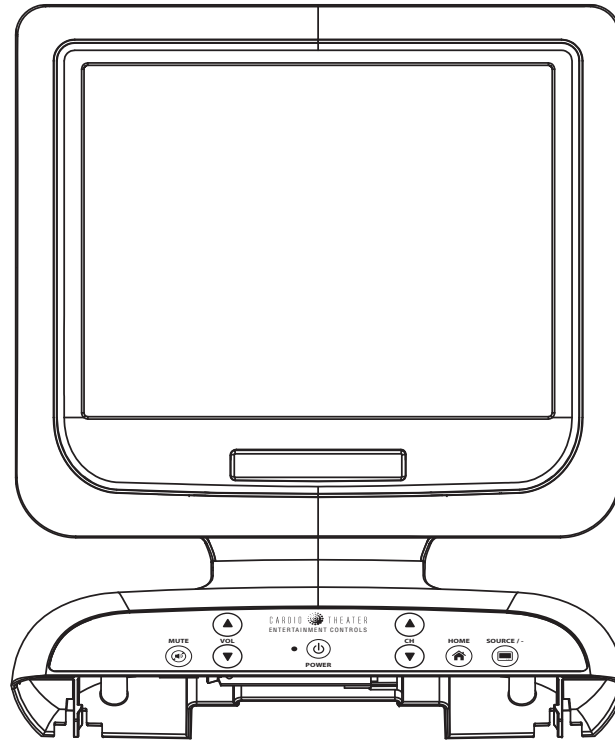

Important Safety Instructions

Always follow basic safety precautions when using this equipment to reduce the chance of personal injury or property damage.

- Read all instructions before installing and using the equipment. Follow any labels on the equipment.
- Use the power adapter provided with the equipment. Plug the power adapter into an appropriate, grounded power outlet as marked on the equipment. Do not use accessory attachments that are not recommended by the manufacturer, as such attachments may cause injuries.
- Position power cables so that they are not walked on or pinched by items placed upon or against them.
- Make sure that the equipment has adequate ventilation. Do not place anything on top of or over the equipment. Do not use on a cushioned surface that could block the ventilation openings.
- Keep the equipment away from water and moisture.
- Locate the equipment away from sources of heat, such as radiators, heat registers, and stoves. Avoid temperature extremes.
- Avoid dropping anything on or spilling anything inside the equipment, because doing so can damage the electronics.
- Do not attempt to service the unit yourself except to follow the maintenance instructions found in this manual.

Broadcast Area Supported

The PVS12EDTL supports ATSC standards in the North American broadcast market.

Product Recycling and Disposal

This equipment must be recycled or discarded according to applicable local and national regulations.

Product labels, in accordance with European Directive 2002/96/EC concerning waste electrical and electronic equipment (WEEE), determine the framework for the return and recycling of used equipment as applicable throughout the European Union. The WEEE label indicates that the product is not to be thrown away, but rather reclaimed upon end of life per this Directive.

In accordance with the European WEEE Directive, electrical and electronic equipment (EEE) is to be collected separately and to be reused, recycled, or recovered at end of life. Users of EEE with the WEEE label per Annex IV of the WEEE Directive must not dispose of end of life EEE as unsorted municipal waste, but use the collection framework available to customers for the return, recycling, and recovery of WEEE. Customer participation is important to minimize any potential effects of EEE on the environment and human health due to the potential presence of hazardous substances in EEE. For proper collection and treatment, refer to *Obtaining Service*.

Radio Frequency Interference (RFI)

Federal Communications Commission, Part 15

WARNING: To prevent fire or electrical shock, do not expose this equipment to rain, moisture or excess heat.

The unit has been tested and found to comply with the limits for Part 15 of the FCC Rules. These limits are designed to provide reasonable protection against harmful interference when the equipment is operated in a commercial environment.

The PVS generates, uses, and can radiate radio frequency energy and, if not installed and used in accordance with the assembly, installation and maintenance instruction manuals, may cause harmful interference to radio communications.

However, there is no guarantee that interference will not occur in a particular installation. If the unit does cause harmful interference to radio or television reception, which can be determined by turning the equipment off and on, the user is encouraged to try to correct the interference by one or more of the following measures:

- Reorient or relocate the receiving antenna.
- Increase the separation between the equipment and the receiver.
- Connect the equipment into a separate outlet that uses a different circuit than the receiver.

Consult a Radio Theater or an experienced radio/TV technician for help.

WARNING: Per FCC rules, changes or modifications not expressly approved by Radio Theater could void the user's authority to operate the equipment.

Industry Canada

This Class A digital apparatus complies with Canadian ICES-003.

Cet appareil numérique de la classe A est conforme à la norme NMB-003 du Canada.

Table of Contents

Important Safety Instructions	1	Picture Menu	25
Broadcast Area Supported	1	Sound Menu	26
Product Recycling and Disposal	1	Special Menu	27
Radio Frequency Interference (RFI)	2	Manual Time Setting	28
Before You Begin	4	Sleep Timer	29
Installation Information	6	Parental Controls	30
Suggested Tools	6	Caption	30
Obtaining Service	6	Auto Power On	30
Basic Operation - Master Reset and		Input Selection	31
Controller Programming	7	Picture & Sound Settings	31
On Screen Display Menus	8	Using the Optional Personal Entertainment Player	32
Initial Search for Channels - Setup Menu	10	How to Use the Personal Player	33
Tuning Band	10	Maintenance and Troubleshooting	34
Auto Channel Search	11	Cleaning the PVS and Controller	34
Add On Channel Search	12	Replacing the Headphone Jack	35
Manually Blocking Channels	13	Troubleshooting the PVS	36
DTV Signal Strength	14	Appendix - Optional Remote Control	37
Channel Labels	15	Limited Warranty	38
Menu Language	16		
Using the Controller to Set Up Custom Features	17		
Automatic Power On/Off	18		
Home Button	19		
Inactivity Timer	20		
Closed Caption On/Off	21		
Promotional Information Content (PIC)	22		
Master Reset	24		

Before You Begin

The Cardio Theater Personal Viewing System (PVS) adds personalized entertainment to workouts. A person steps on the exercise equipment, plugs headphones into the jack, selects a TV program using the **Channel** buttons, and begins exercising. The program appears on a bright, full-color liquid crystal display (LCD) directly in front of the person, rather than at a distance on the wall.

Volume buttons on the integrated controller allow a person to change the audio level. Depending on how the PVS screen is configured, Closed Captioning may appear allowing people to exercise without headphones.

Figure 1 shows the PVS12EDTL screen and integrated controller.

You may have an integrated controller that includes the Personal Entertainment Player (PEP). The PEP allows people to exercise while listening to music or watching video from a personal player. For more information about the PEP, refer to the *Using the Optional Personal Entertainment Player* section in this guide.

The PVS12EDTL supports both analog and digital programming. The On Screen Display Menus allow you to set up the channels and customize the PVS screen. You need to select which channel and type you are programming for: analog or digital. The PVS screen briefly displays the channel number preceded by an “A” or “D” to differentiate between analog and digital channels.

Refer to *On Screen Display Menus* for an overview of the display menus. In addition to the On Screen Display Menus, there are a number of custom features available through the controller that a fitness facility might want to use, such as Automatic Power On/Off, Headphone Inactivity Timer, Home button, etc.

Important: Refer to *Using the Controller to Set Up Custom Features for instructions on programming.*

The integrated controller includes a feature that gives a person the chance to quickly re-insert the headphones if they become accidentally disconnected. If the headphones are re-inserted within 15 seconds, the integrated controller will not perform any of the custom headphone detection features, such as the Inactivity Timer or Automatic Power On/Off.

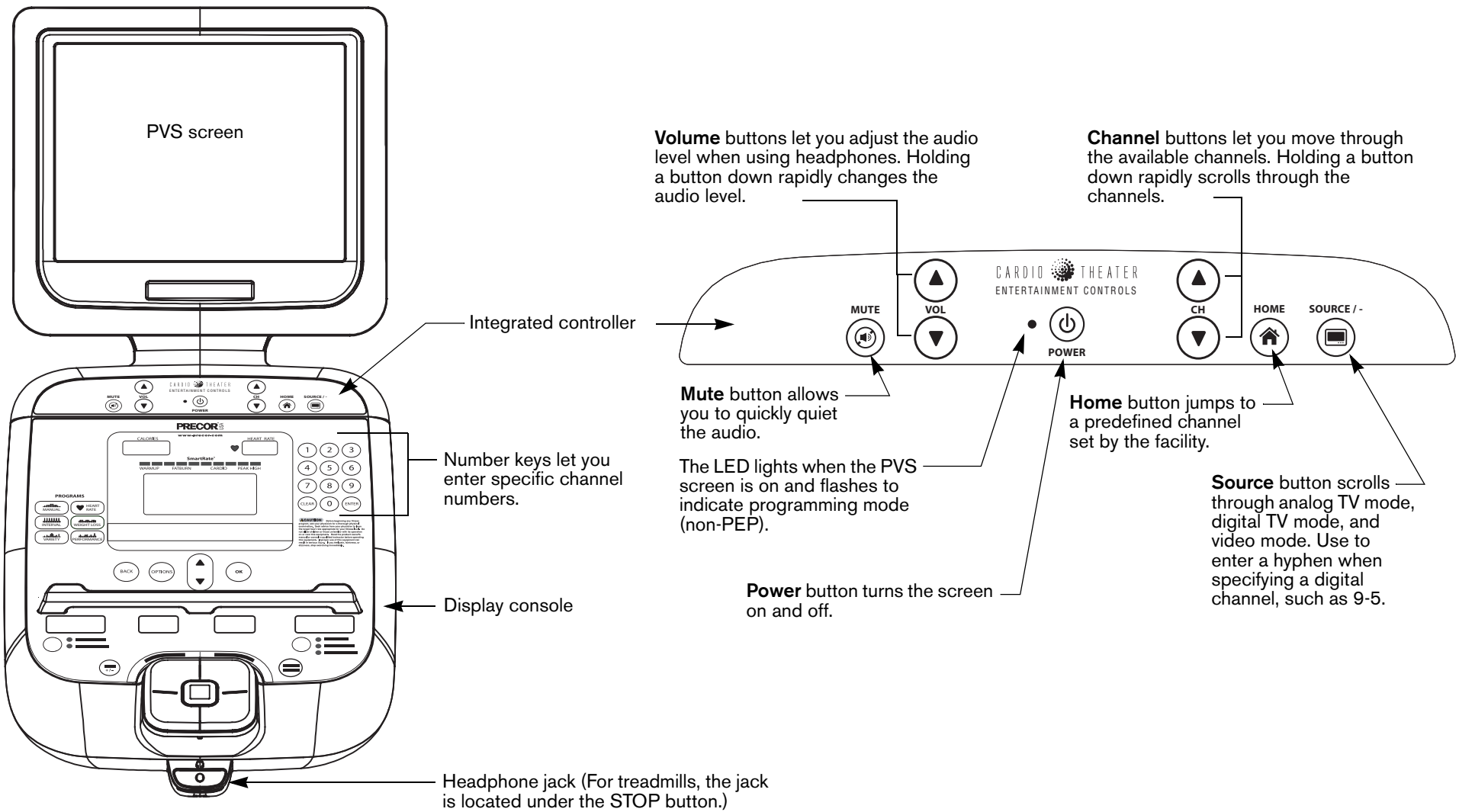

Figure 1: Overview of PVS screen and integrated controller (non-PEP)

Installation Information

This guide explains how to set up the analog and digital channels. It also explains how to program the custom features, gives an overview of the PVS menus and screens, and covers any maintenance requirements. For proper operation and maintenance, please read this guide thoroughly and follow the instructions.

Fitness facilities can add a PVS and its integrated controller to any Precor Experience line of exercise equipment. The screen is attached to a bracket which is installed behind the display console. The 8-button controller is integrated into the console design.

Both the PVS screen and integrated controller receive power from a standard AC power outlet. They do not rely on power from the exercise equipment. Some custom features, however, such as setting up the **Home** button, use the 0–9 keys on the display console keypad.

Note: If you are using the Precor Experience line of self-powered equipment, you will need an optional power adapter to supply power to the display console. An alternative option is to exercise on the self-powered equipment while programming the custom features.

For information about installing the PVS on a display console, refer to the *Personal Viewing System (PVS) Assembly Guide*.

Suggested Tools

The PVS is designed so you can program it using a combination of controller buttons and keys on the display console. However, you may find some programming is easier with the optional remote control. Contact your Cardio Theater dealer to order one or more remote controls as desired.

To add the optional power adapters to the self-powered equipment in your facility, check with your Precor dealer.

Obtaining Service

Do not attempt to service any of the equipment except as described in this guide. For information about product operation or service, refer to the Cardio Theater website at www.cardiotheater.com or contact an authorized Cardio Theater Technical Support Representative at 1-800-776-6695 or service@cardiotheater.com. Representatives are available to serve you from 6:00 am to 5:00 pm, Monday through Friday, U.S.A. Pacific Time.

Returning Equipment to Cardio Theater

To return equipment to Cardio Theater for any reason, you must contact Cardio Theater Technical Support and obtain a return authorization (RMA) number. When requesting the RMA number, explain why you are returning the equipment, for example you ordered too many controllers and the extra controller can be returned to stock, or the equipment needs repairs.

Important: *Equipment must be shipped with an RMA number in order for Cardio Theater to process it. Any equipment received without an RMA number will be returned to the sender.*

Basic Operation - Master Reset and Controller Programming

After you install the PVS hardware and complete all power and cable/antenna connections, you can turn on the PVS screen and program the channels and custom features. First, however, the integrated controller must be programmed to support the PVS screen.

Figure 2 illustrates which buttons to push in sequence to perform a master reset and program the controller. Two buttons together indicate that those buttons need to be pressed simultaneously and held for a minimum of 3 seconds. Follow the steps illustrated in Figure 2, or read and perform the same steps written in the adjacent column.

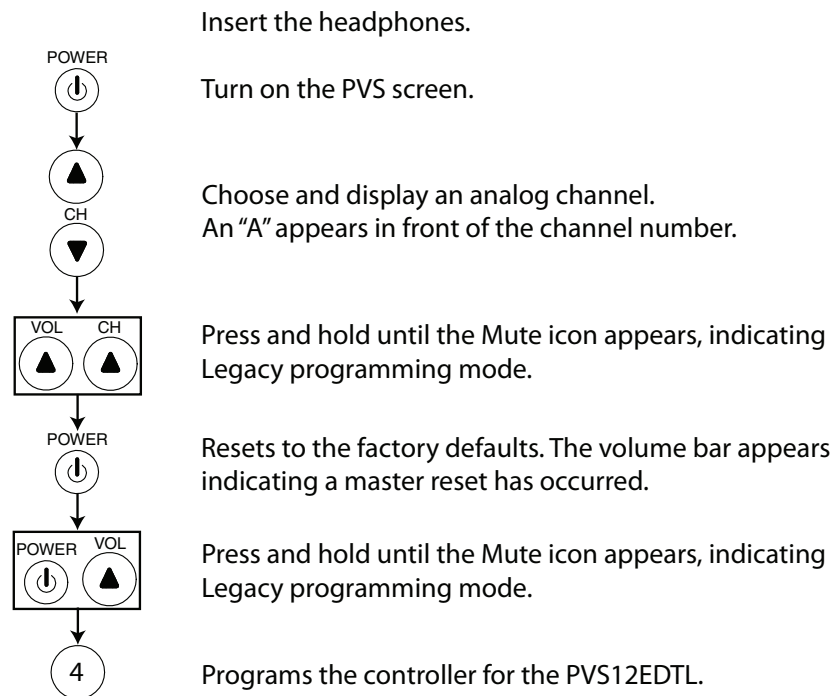

Figure 2: Initiate a Master Reset and program the controller for the PVS.

To perform a master reset and program the integrated controller:

1. Plug in the headphones. This assures that the PVS screen will not turn off while you are programming.
 2. Press the **Power** button on the controller to turn on the PVS screen.
 3. Use the **Channel ▲ ▼** buttons, to move to an analog channel. An "A" appears before the channel number.
 4. Simultaneously press and hold both **Volume ▲** and **Channel ▲** buttons until the Mute icon appears (about 3 seconds). The Mute icon, which momentarily appears on the screen, indicates that the PVS screen has entered Legacy programming mode. The audio is muted.
 5. Press the **Power** button. A master reset occurs and all the features on the integrated controller return to the factory defaults. The volume bar appears on the screen, which confirms that a master reset has taken place, and then the PVS screen returns to normal viewing mode.
 6. Simultaneously press and hold both **Power** and **Volume ▲** buttons until the Mute icon appears (about 3 seconds).
 7. Press **4** to program the controller for the PVS12EDTL.
- The volume bar appears confirming the entry and the PVS screen returns to normal viewing mode.

Important: Reprogram the controller whenever someone initiates a master reset of all the custom features. Otherwise, the controller may not correctly operate the PVS screen.

On Screen Display Menus

The On Screen Display Menus provide Picture, Sound, Special (custom) and Setup features. Each of the four menus provides further options. Figures 3 through 4 illustrate the available menus.

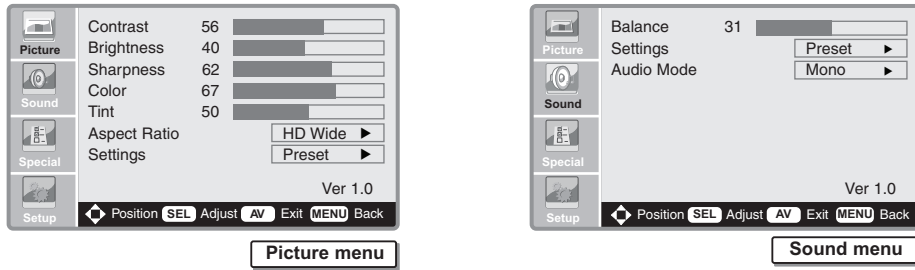

Figure 3: Picture menu and Sound menu

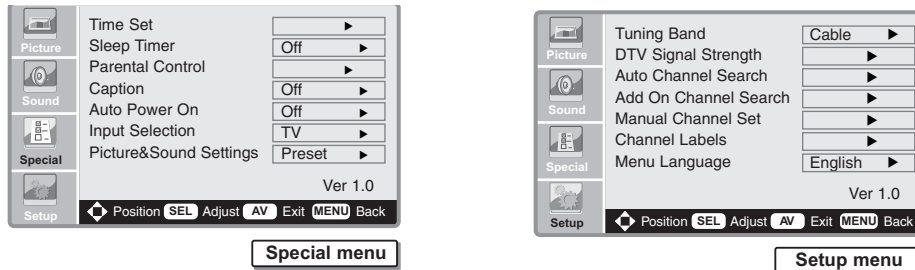

Figure 4: Special menu and Setup menu

Note: The button callouts that appear at the base of these displays do not apply to the integrated controller, they pertain to the optional remote control.

When you successfully enter programming mode, audio is muted and the Mute icon appears momentarily on the screen. Programming mode remains active for 15 seconds after the last key press. You can continue to make selections in programming mode as long as you do not let the 15-second time period elapse between key presses. To exit programming mode, wait 15 seconds without pressing any keys. The display returns to normal viewing mode.

Note: If you have the non-PEP controller, the green LED blinks to indicate programming mode. The LED stops blinking when the 15-second time period elapses and the TV exits programming mode.

Refer to the Table 1 for information about the functionality of the controller buttons during programming mode.

Table 1: How the Controller buttons function within the menus.

Action	Controller
Access Menu	Press and hold both Volume ▼ and Channel ▼ buttons until the Mute icon appears (3 seconds).
Move up and down to highlight a particular menu	Use Channel ▲ and ▼ buttons
Select an item	Press Power button
Change a parameter value	Use Volume ▲ button
Go back to the previous menu level	Press Mute button

Figure 5 illustrates which buttons to push in sequence to access the display menus. Two buttons together indicate that those buttons need to be pressed simultaneously and held for a minimum of 3 seconds. Follow the steps illustrated in Figure 5, or read and perform the same steps written on the next page.

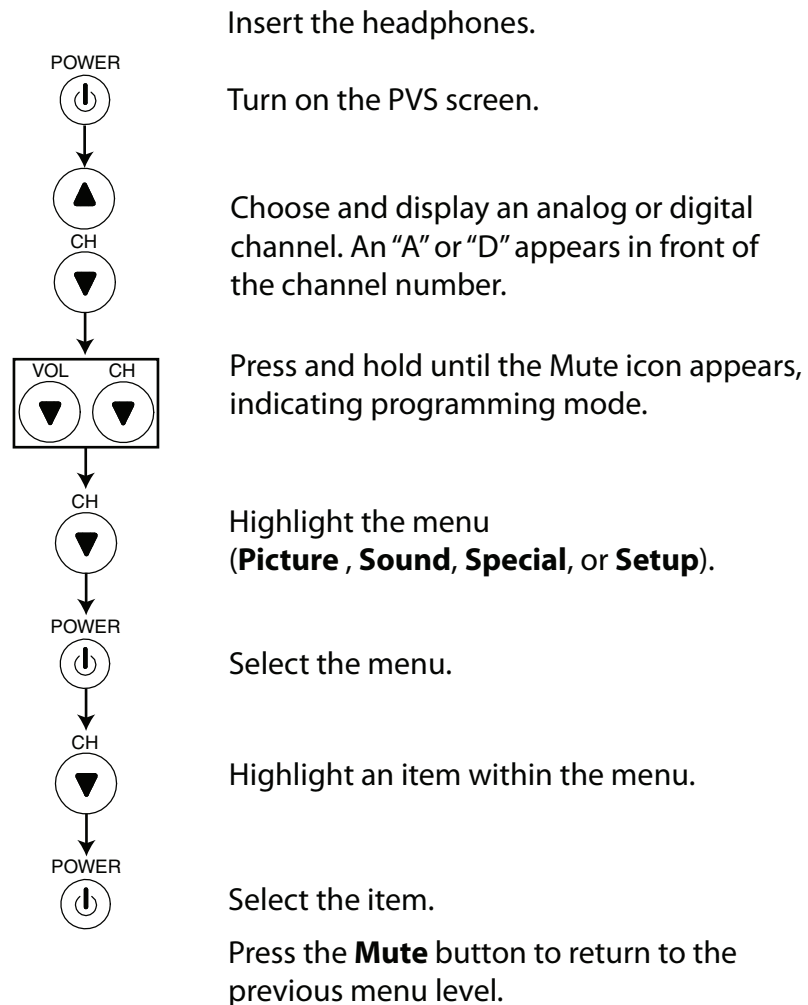

Figure 5: Accessing the menus

To access the menus, take the following steps:

1. Plug in the headphones. This assures that the PVS screen will not turn off while you are programming.
2. Press the **Power** button on the controller to turn on the PVS screen.
3. Use the **Channel ▲ ▼** buttons, to move to an analog or digital channel. An "A" or "D" appears before the channel number.
4. Simultaneously press and hold both **Volume ▼** and **Channel ▼** buttons until the Mute icon appears (about 3 seconds). The Mute icon, which momentarily appears on the screen, indicates that the PVS screen has entered programming mode. The audio is muted.
5. Use the **Channel ▼** button to highlight each menu.
6. Press **Power** to select the menu.
7. Press **Channel ▼** button to highlight the options within the menu.
8. Press **Power** to select the option.

Initial Search for Channels - Setup Menu

To program the channels on the PVS, simply choose the tuning band and run the automatic channel search feature in the Setup menu. When the search is complete, the screen displays the analog and digital channels that are available in the tuning band you selected.

Tuning Band

Figure 6 illustrates which buttons to press in sequence to identify the signal source for the PVS screen. You need to select the Tuning Band before performing a channel search.

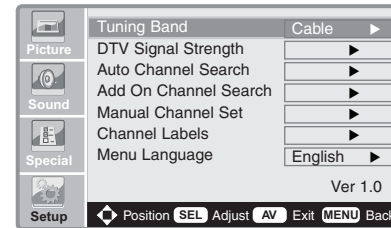
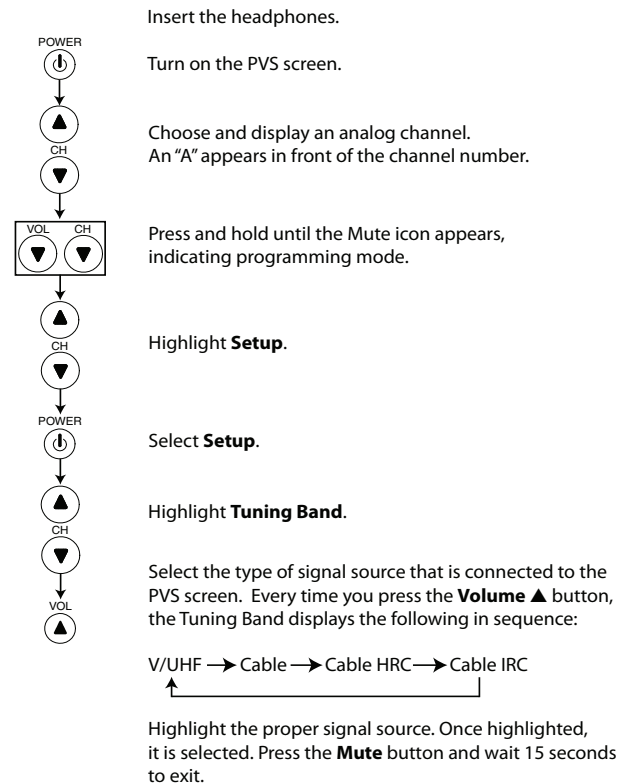

1. Plug in the headphones. This assures that the PVS screen will not turn off while you are programming.
 2. Press the **Power** button on the controller to turn on the PVS screen.
 3. Use the **Channel ▲ ▼** buttons, to move to an analog channel. An "A" appears before the channel number.
 4. Simultaneously press and hold both **Volume ▼** and **Channel ▼** buttons until Mute icon appears (about 3 seconds). The Mute icon, which momentarily appears on the screen, indicates that the PVS screen has entered programming mode. The audio is muted.
- Note:** While you are in programming mode, if you do not press a button within 15 seconds, the PVS screen exits programming mode and the display returns to normal viewing mode.
5. Press the **Channel ▼** button to highlight the Setup menu.
 6. Press **Power** to select the Setup menu.
 7. Press the **Channel** buttons to highlight Tuning Band.
 8. Press **Volume ▲** to select the appropriate signal source.

Note: With the proper Tuning Band selected, use **Channel ▼** to highlight Auto Channel Search and press the **Power** button. Refer to *Auto Channel Search*.

Figure 6: Identify the PVS screen's signal source.

Auto Channel Search

To perform an automatic channel search, you first need to select the signal source. If you haven't already followed the steps in *Tuning Band*, do so before following the sequence in Figure 7.

Note: If the 15-second time period has not elapsed, you are still in programming mode. Use a **Channel** button to highlight Auto Channel Search and then press **Power**.

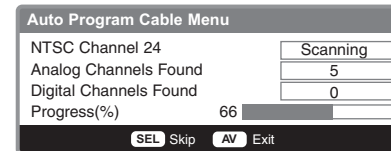
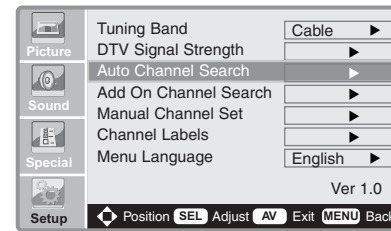
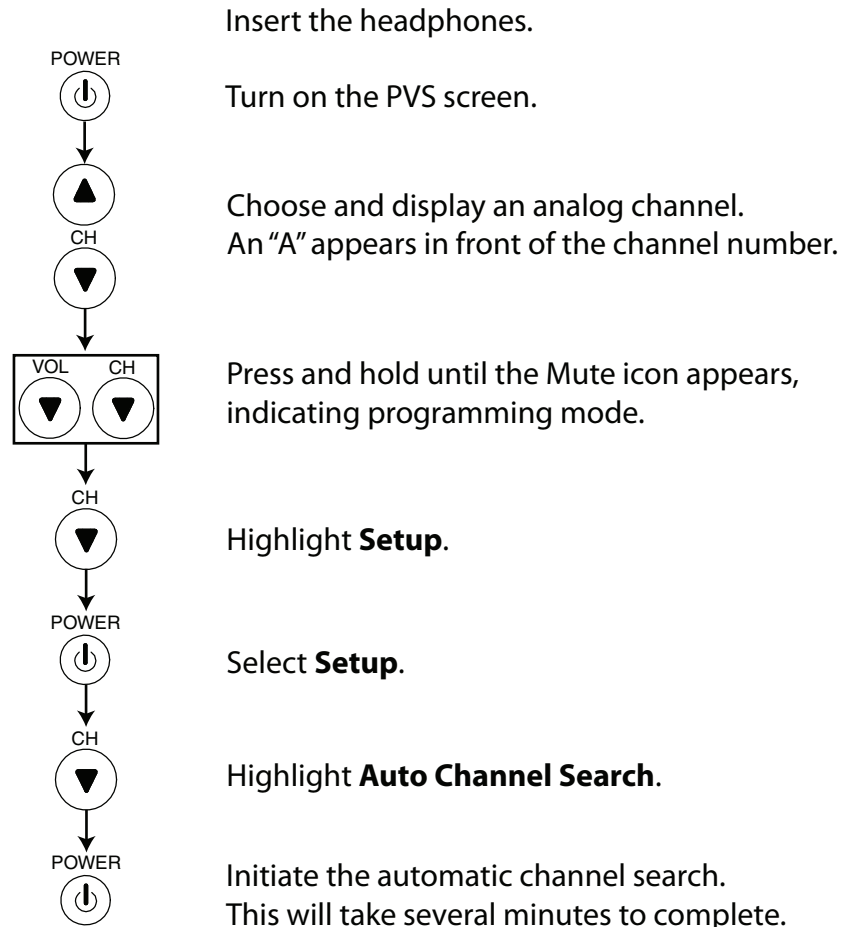

1. Access programming mode. Refer to Figure 7.
2. Press the **Channel** ▼ button to highlight the Setup menu.
3. Press the **Power** button to select it.
4. Press the **Channel** buttons to highlight Auto Channel Search.
5. Press the **Power** button to start the search.

The search process may take several minutes to finish. The PVS searches for analog channels first, and then searches for digital channels. A progress bar provides a visual aid.

When the PVS finds a channel with enough signal strength, it logs the number in the appropriate analog or digital field.

Note: Before the 15-second time period elapses, you can press the **Power** button 3 times quickly to stop the automatic programming process. After the 15-second time period elapses, you can press the **Home** button to stop the automatic programming process.

After you exit programming mode and the screen returns to normal viewing mode, press the **Channel** buttons to scroll through the analog and digital channels. Refer to *Manually Blocking Channels* to view a list of the available channels.

Figure 7: initiate an automatic channel search.

Add On Channel Search

This feature operates the same as the Auto Channel Search when you use the integrated controller. It rescans and selects the viable channels.

When you use the optional remote control and the automatic channel search is interrupted, you can continue where you left off using the Add On Channel Search.

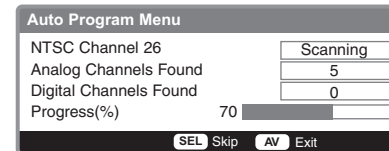
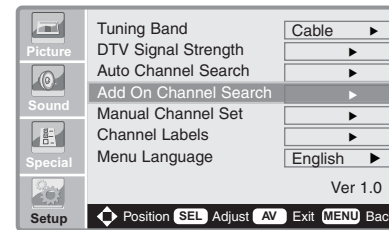
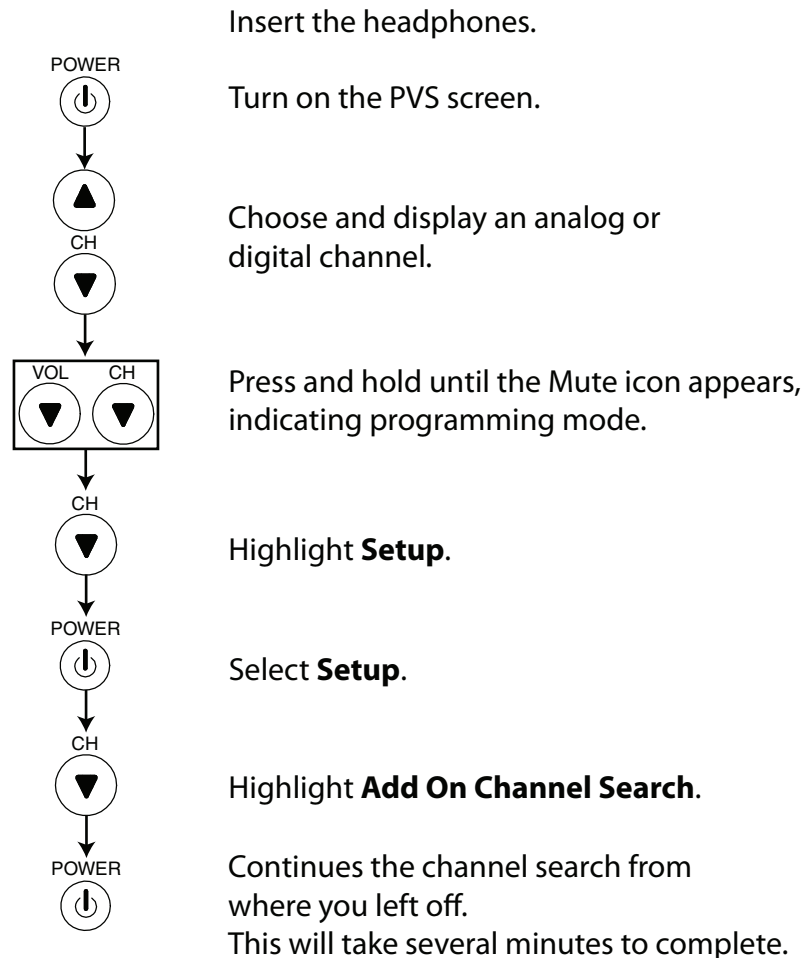

1. Access programming mode. Refer to Figure 8.
2. Press the **Channel ▼** button to highlight the Setup menu.
3. Press the **Power** button to select it.
4. Press the **Channel ▼** button to highlight Add On Channel Search.
5. Press the **Power** button to start the search.

As a continuation of the Automatic Channel Search the process may take several minutes to finish. The PVS searches for analog channels first, and then searches for digital channels. A progress bar provides a visual aid.

When the PVS finds a channel with enough signal strength, it logs the number in the appropriate analog or digital field.

Note: Before the 15-second time period elapses, you can press the **Power** button 3 times quickly to stop the automatic programming process. After the 15-second time period elapses, you can press the **Home** button to stop the automatic programming process.

Figure 8: Continue a channel search

Manually Blocking Channels

Follow these instructions to block a channel.

Note: Blocking access to a channel does not necessarily mean it is unavailable. Patrons may still access a channel if they use the number buttons. For example, if you block channel A 16-0, and a person enters 16 with the number buttons, that channel will appear on the PVS screen. However, when a person uses the **Channel** buttons to scroll through the available channels, channel A 16-0 will not appear.

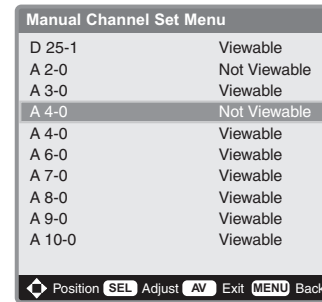
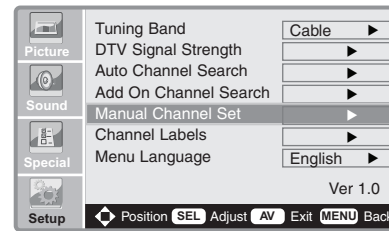
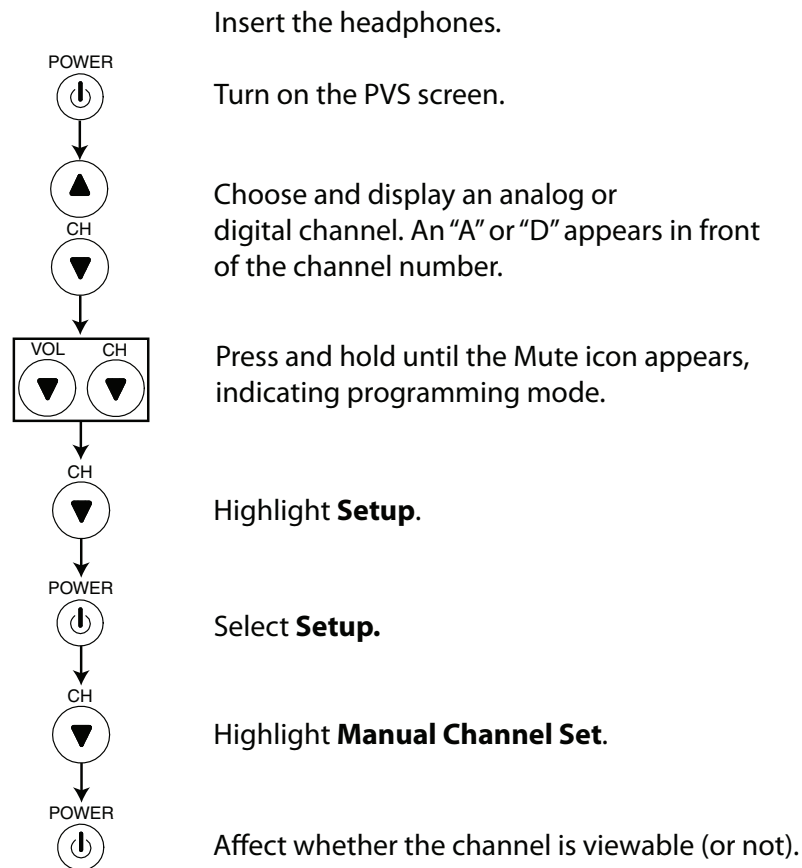

1. Access programming mode. Refer to Figure 9.
2. Press the **Channel** ▼ button to highlight the Setup menu.
3. Press the **Power** button to select it.
4. Press the **Channel** ▼ button to highlight Manual Channel Set.
5. Press the **Power** button to select it.
6. Press the **Channel** buttons to highlight a channel.
7. Press the **Power** button to affect whether the channel is accessible (viewable) or not. The **Power** button toggles between two choices.
8. When you are finished, return to normal viewing mode and use the **Channel** buttons to scroll through the channels and verify that the desired channels have been blocked.

Figure 9: Blocking channels

DTV Signal Strength

Choosing this menu item lets you view the digital signal strength of the current channel. You need to access programming mode from a digital channel to view its DTV signal.

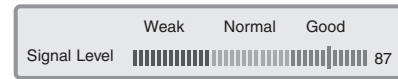
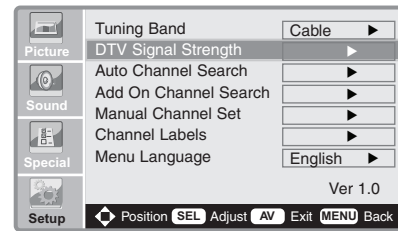
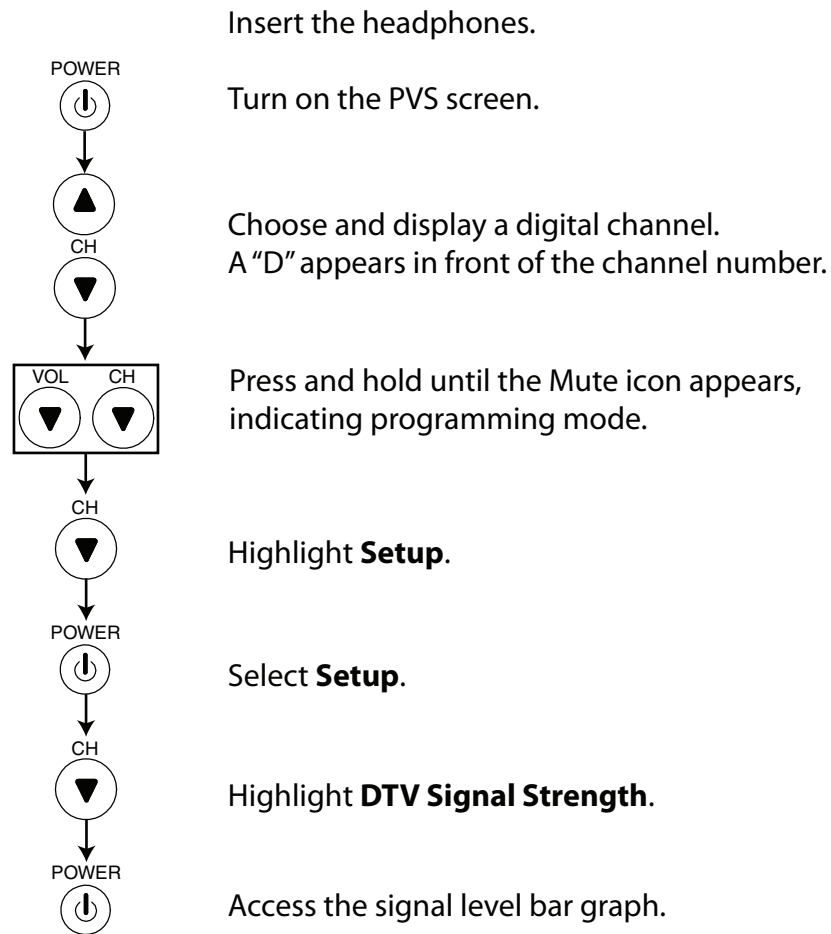

1. Select a digital channel on the PVS screen.
2. Access programming mode. Refer to Figure 10.
3. Press the **Channel ▼** button to highlight the Setup menu.
4. Press the **Power** button to select it.
5. Press the **Channel** buttons to highlight DTV Signal Strength.
6. Press the **Power** button to determine the signal strength of the current channel. You may want to note the weak signal channels and delete them from the selection list. Refer to *Manually Blocking Channels*.
7. To determine the signal strength of another digital channel, return to normal viewing mode, select the channel, and repeat steps 1 through 6.

Figure 10: Viewing the DTV Signal Strength

Channel Labels

If you wish to customize channels with an alternate number or give it a specific name, you can use the following instructions with the integrated controller.

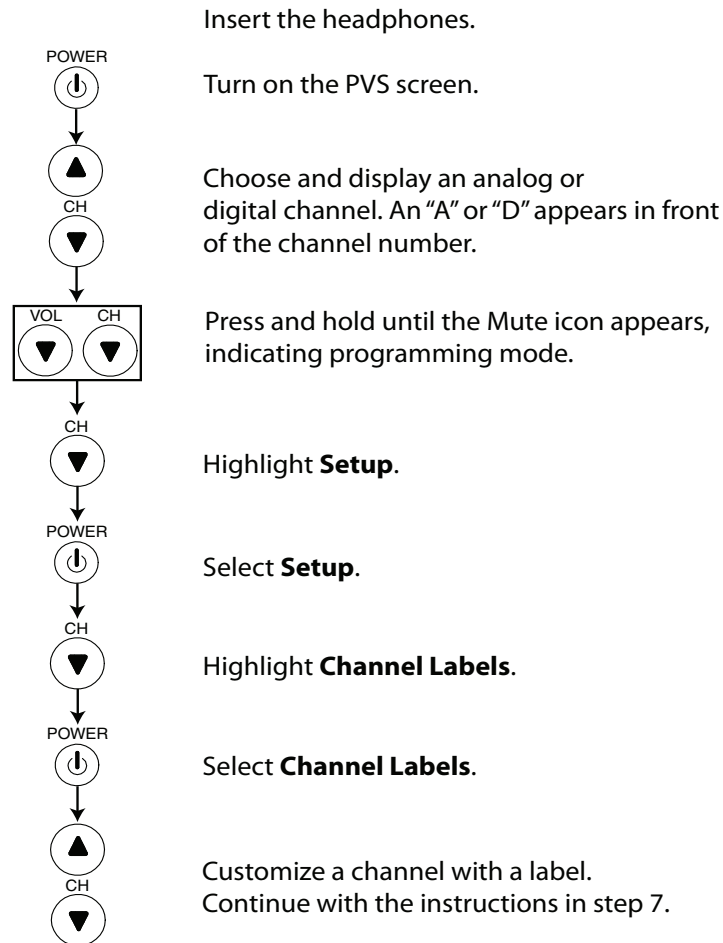

Figure 11: Changing the channel's label

Note: The optional remote control is easier to use when assigning a channel an alternate number or name. Refer to the *Appendix - Optional Remote Control*.

1. Access programming mode. Refer to Figure 11.
2. Press the **Channel ▼** button to highlight the Setup menu.
3. Press the **Power** button to select it.
4. Press the **Channel ▼** button to highlight Channel Labels.
5. Press the **Power** button to select it.
6. Press the **Channel** buttons to highlight a channel.
7. Press the **Volume ▲** button to tab to the next field.
8. Press the **Channel** buttons to cycle through the alphabet and numbers 0 through 9. When the letter or number you want is displayed, press the **Volume ▲** button to tab to the next field.
9. When you have completed the new label, return to normal viewing mode and use the **Channel** buttons to view the new channel labels.

Menu Language

If you want to change the language that appears in the menu screens, you would use this feature.

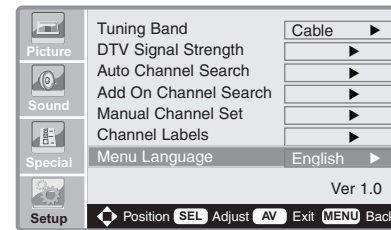
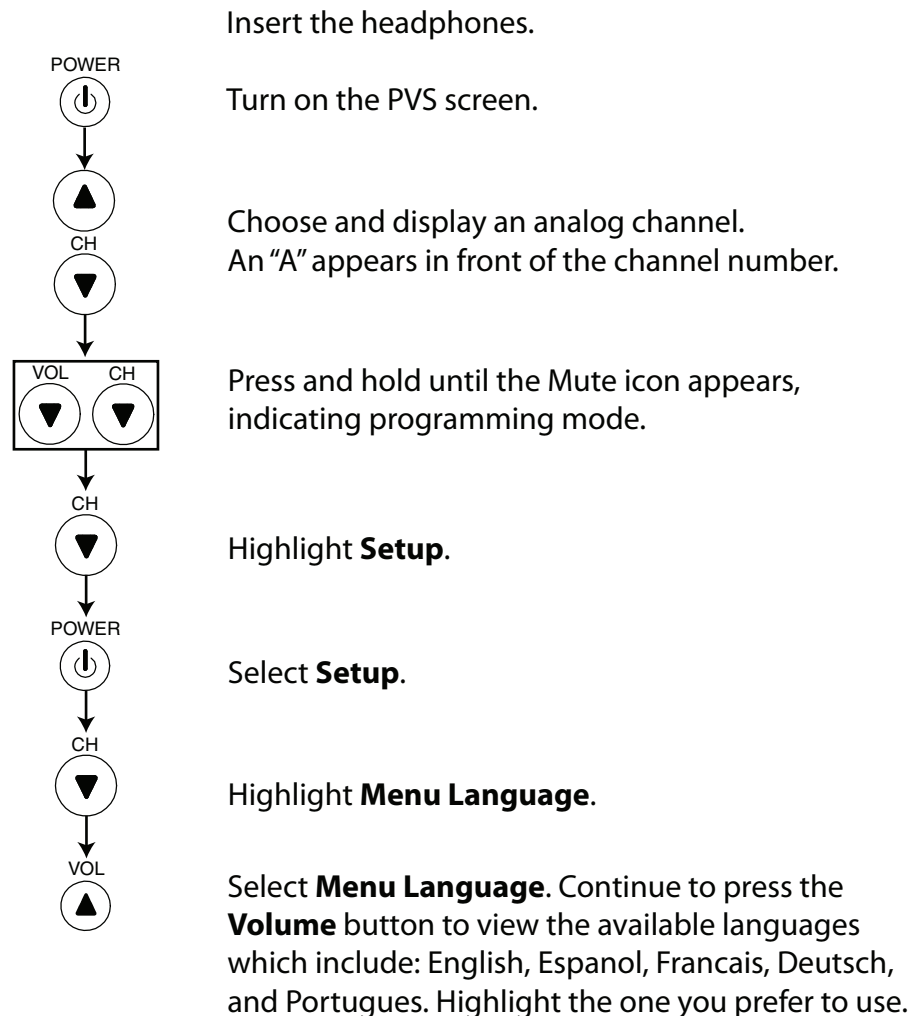

1. Access programming mode. Refer to Figure 12.
2. Press the **Channel** ▼ button to highlight the Setup menu.
3. Press the **Power** button to select it.
4. Press the **Channel** buttons to highlight Menu Language.
5. Press the **Volume** ▲ button to select it. Continue to press the **Volume** ▲ button to cycle through the available languages and highlight the one you wish to use: English, Espanol, Francais, Deutsch, Portugues.

Figure 12: Choosing a language

Using the Controller to Set Up Custom Features

Cardio Theater has customized a number of features that are commonly used in a fitness facility. The customization allows you to easily enable or disable a feature using the integrated controller. Use of these features is optional.

- **Automatic Power On/Off** feature causes the PVS screen to turn off automatically when headphones are removed and turn on when headphones are inserted.
- **Home button** feature lets you specify the channel that will appear when someone presses the **Home** button. If the Inactivity Timer feature is enabled, it will cause this channel to appear when the headphones are removed from the jack.
- **Inactivity Timer** feature causes the screen to display the channel configured for the **Home** button when headphones are removed from the jack. This feature does not work when the Automatic Power On/Off feature is enabled.
- **Closed Caption On/Off** feature causes the screen to display Closed Captioning (CC1 standard) when no headphones are connected. This feature does not work when the Automatic Power On/Off feature is enabled. This feature is also not available with PAL-compliant PVS screens.
- **Promotional Information Content (PIC)** feature prompts a specific channel for a preset time before a patron can use the controller to select a different program. You might use this feature to show an informational program or commercial. This feature occurs after headphones are inserted.

This section provides instructions for setting up the custom features. To set up these features, you access the programming mode by pressing a specific combination of buttons on the controller.

Note: While you are in programming mode, if you do not press a button within 15 seconds, the PVS screen exits programming mode, and the display returns to normal viewing mode.

You can set up only one custom feature at a time. As soon as you program a feature, you exit the Legacy programming mode and the PVS screen returns to normal viewing mode.

Important: You must use the integrated controller to set up these custom features. The optional remote control accesses the standard PVS features, but not the customized Cardio Theater features.

Automatic Power On/Off

The Automatic Power On/Off feature turns the PVS screen on automatically when headphones are inserted into the headphone jack. At the end of the exercise session, when the headphones are removed from the jack, the screen turns off after approximately 10–20 seconds. This feature is typically used to conserve power and lengthen screen life. If this feature is enabled, it overrides any other headphone detection features.

Use the integrated controller. The optional remote control cannot access these procedures.

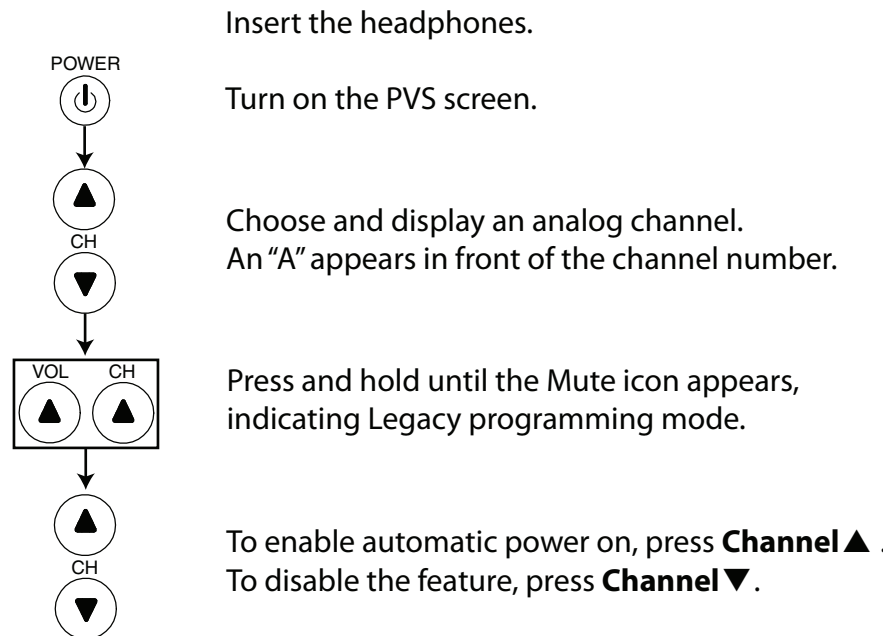

Figure 13: Programming the Automatic Power On/Off feature

1. Plug in the headphones. This assures that the PVS screen will not turn off while you are programming.
2. Press the **Power** button on the controller to turn on the PVS screen.
3. Use the **Channel ▲ ▼** buttons, to move to an analog channel. An "A" appears before the channel number.
4. Simultaneously press and hold both **Volume ▲** and **Channel ▲** buttons until the Mute icon appears (about 3 seconds). The Mute icon, which momentarily appears on the screen, indicates that the PVS screen has entered Legacy programming mode. Audio is muted.

If nothing happens, try pressing both **Volume ▲** and **Channel ▲** buttons at the same time again.

Note: While you are in programming mode, if you do not press a button within 15 seconds, the PVS screen exits programming mode and the display returns to normal viewing mode.

5. Choose one based on what you want to do:

If you want to...	Then...
Enable the feature	Press the Channel ▲ button
Disable the feature	Press the Channel ▼ button

As soon as you press a button, the volume bar appears briefly confirming the entry, and the PVS screen returns to normal viewing mode.

6. To confirm that the PVS screen will turn off, unplug the headphones and wait up to 20 seconds.

If the screen turns off, the feature has been enabled.

If the screen does not turn off, repeat these steps until it is configured properly.

Home Button

This feature lets you specify a channel that will appear when the **Home** button is pressed. Use this feature to allow patrons quick access to an in-house channel or special information channel.

You can specify either an analog or digital channel as the home channel. However, to select the channel, you must have the correct PVS screen mode showing: either analog or digital.

If you enable the Inactivity Timer feature, it will cause the home channel to appear when the headphones are removed from the jack.

Note: The **Home** button is always enabled with the programmed channel; you cannot disable this feature.

Use the integrated controller. The optional remote control cannot access these procedures.

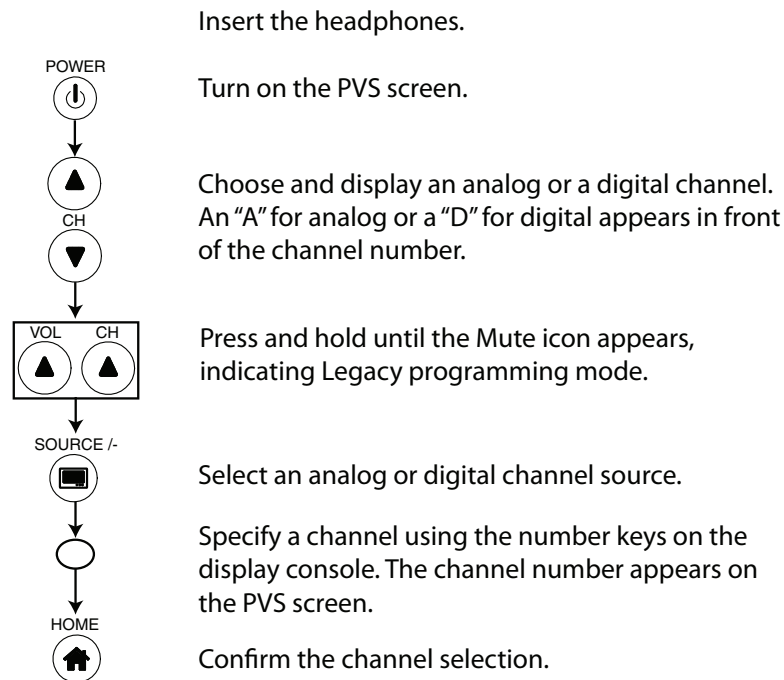

Figure 14: Configuring the Home button channel

1. Plug in the headphones. This assures that the PVS screen will not turn off while you are programming.
2. Press the **Power** button on the controller to turn on the PVS screen.
3. Use the **Channel ▲ ▼** buttons, to move to an analog channel. An "A" appears before the channel number.
4. Simultaneously press and hold both **Volume ▲** and **Channel ▲** buttons until the Mute icon appears (about 3 seconds). The Mute icon, which momentarily appears on the screen, indicates that the PVS screen has entered Legacy programming mode. Audio is muted.
5. Press the **Source** button one or more times to move to an analog or a digital channel. You must be in the correct analog or digital mode for the channel you want to specify.
6. Specify the desired channel.

To specify a digital channel, such as 9-5, use **Source** for the hyphen. For example, you would enter 9, press **Source**, and then enter 5.

7. Press the **Home** button.
8. Change the channel so the one you programmed as the home channel is not displayed.
9. Confirm that the **Home** button was properly programmed by pressing the **Home** button.

The volume bar briefly appears confirming the entry. Then the PVS screen returns to normal viewing mode. The channel you specified for the **Home** button displays on the screen.

If the channel you programmed appears, do nothing. The programming is complete. Otherwise, repeat these steps to configure it correctly.

Note: The factory default home channel is channel 4.

Inactivity Timer

This feature lets you program the screen to display the channel that is configured for the **Home** button when headphones are removed from the jack. This allows the fitness facility to have an in-house or informational channel on the PVS screen when the equipment is not currently in use.

Use the integrated controller. The optional remote control cannot access these procedures.

You cannot use the Inactivity Timer feature with the Automatic Power On/Off feature. The Automatic Power On/Off feature turns off the screen when headphones are removed from the headphone jack.

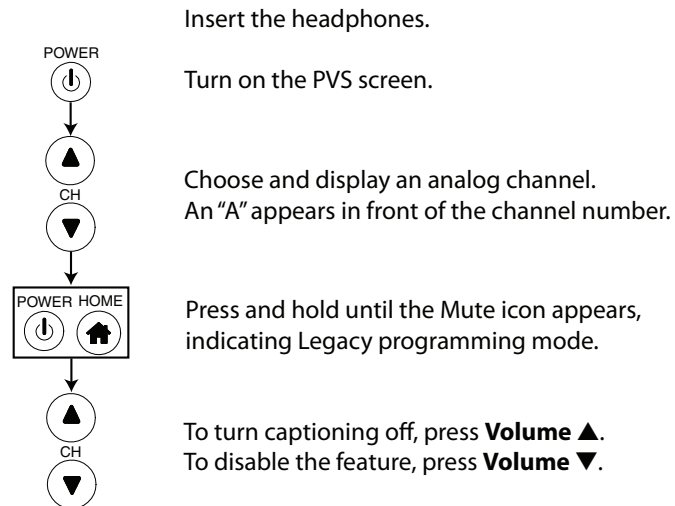

Figure 15: Setting the Inactivity Timer

1. Plug in the headphones. This assures that the PVS screen will not turn off while you are programming.
2. Press the **Power** button on the controller to turn on the PVS screen.
3. Use the **Channel ▲ ▼** buttons, to move to an analog channel. An "A" appears before the channel number.

4. Simultaneously press and hold both **Power** and **Home** buttons until the Mute icon appears (about 3 seconds). The Mute icon, which momentarily appears on the screen, indicates that the PVS screen has entered Legacy programming mode. Audio is muted.
5. Choose one based on what you want to do:

If you want to...	Then...
Enable with a factory-preset time of 15 seconds	<ul style="list-style-type: none"> • Press 0 (or enter nothing). • Press Channel ▲ button to complete the entry.
Enable the feature	<ul style="list-style-type: none"> • Enter up to three numbers to specify the time, from 1 to 255 minutes before the screen changes to the home channel. • Press the Channel ▲ button to complete the entry.
Disable the feature	Press the Channel ▼ button without pressing any number button.

As soon as you press a **Channel** button, the volume bar appears briefly confirming the entry, and the PVS screen returns to normal viewing mode.

6. To confirm that the Inactivity Timer feature is enabled correctly, unplug the headphones and wait the duration that you specified for the Home channel to appear.

If the Home channel appears as you specified, the feature is configured properly.

However, if the Home channel does not appear in the time frame you specified, repeat these steps to configure it correctly.

Note: The default for this feature is disabled.

Closed Caption On/Off

With this feature, Closed Captioning (CC1 standard) displays on the screen when headphones are not plugged into the headphone jack. Then, when headphones are plugged into the jack, the screen stops displaying Closed Captioning. This feature gives people the choice of using headphones to hear the TV program, or not using headphones and simply reading the captioning while they exercise.

Closed Captioning is provided by the TV programming. Some TV programs may not provide Closed Captioning. The Closed Caption On/Off feature displays captioning only when it is available.

Use the integrated controller. The optional remote control cannot access these procedures.

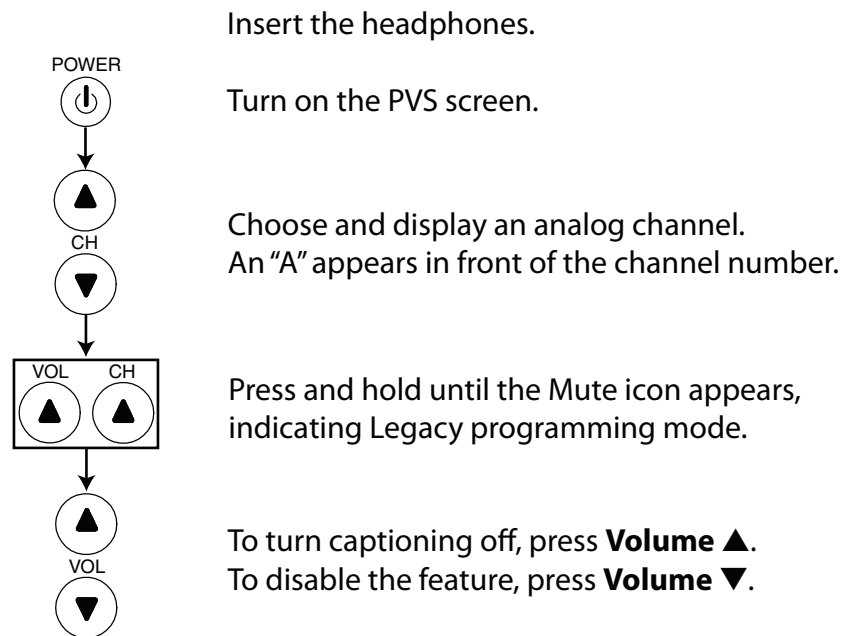

Figure 16: Selecting Closed Captioning

You cannot use the Closed Caption On/Off feature with the Automatic Power On/Off feature. The Automatic Power On/Off feature turns off the screen when headphones are unplugged from the headphone jack.

Important: Do not use the optional remote control to turn off and on Closed Captioning. Doing so will affect the proper functionality of this feature.

1. Plug in the headphones. This assures that the PVS screen will not turn off while you are programming.
2. Press the **Power** button on the controller to turn on the PVS screen.
3. Use the **Channel ▲ ▼** buttons, to move to an analog channel. An "A" appears before the channel number.
4. Simultaneously press and hold both **Channel ▲** and **Volume ▲** buttons until the Mute icon appears (about 3 seconds). The Mute icon, which momentarily appears on the screen, indicates that the PVS screen has entered Legacy programming mode. Audio is muted.
5. Choose one based on what you want to do:

If you want to...	Then...
Enable the feature	Press the Volume ▲ button. A "Caption Off" message appears.
Disable the feature	Press the Volume ▼ button.

As soon as you press a **Volume** button, the volume bar appears briefly confirming the entry, and the PVS screen returns to normal viewing mode.

Note: The default for this feature is disabled.

Promotional Information Content (PIC)

The Promotional Information Content (PIC) feature lets you determine what a person sees when he or she starts to exercise. With this feature enabled and a person plugs in headphones, the controller immediately blocks any interaction with the buttons for a preset period, the LED begins flashing slowly (non-PEP only), and the controller displays a predefined channel. After the preset period passes, the home channel appears, the controller returns functionality, and the person can select any desired channel.

Use this feature so patrons can view promotional material or an informational program about the fitness facility. You can program a digital or analog channel.

Use the integrated controller. The optional remote control cannot access these procedures.

1. Plug in the headphones. This assures that the PVS screen will not turn off while you are programming.
2. Press the **Power** button on the controller to turn on the PVS screen.
3. Use the **Channel ▲ ▼** buttons, to move to an analog channel. An “A” appears before the channel number.
4. Simultaneously press and hold both **Power** and **Home** buttons until the Mute icon appears (about 3 seconds). The Mute icon, which momentarily appears on the screen, indicates that the PVS screen has entered Legacy programming mode. Audio is muted.

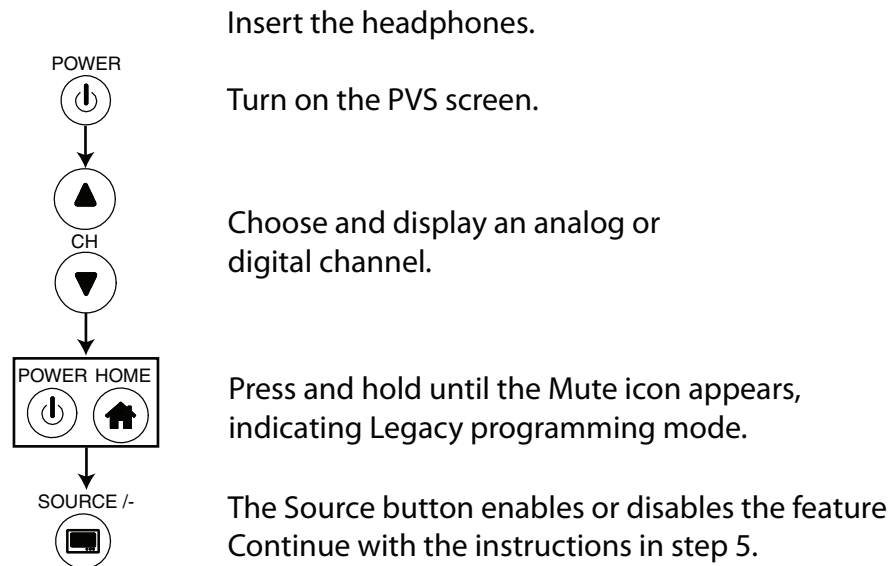

Figure 17: Customizing the Promotional Content channel

5. Choose one based on what you want to do:

<i>To...</i>	<i>Then...</i>
Enable this feature with a factory-preset delay of 15 seconds	<ul style="list-style-type: none"> • Press the Source button one or more times to display an analog or digital channel. • Specify the desired “commercial channel.” • Press the Home button. The Mute icon appears. • Do nothing for at least 20 seconds. The LED will blink on the controller (non-PEP only) while it records updated settings.
Enable with delay that you specify	<ul style="list-style-type: none"> • Press the Source button one or more times to display an analog or digital channel. • Specify the desired “commercial channel.” • Press the Home button. The Mute icon appears. • Specify the desired time delay in seconds, from 5 to 255, in one second increments, using the number buttons. • Press the Home button again.
Disable this feature	<ul style="list-style-type: none"> • Press the Source button once. The Mute icon appears. • Press 0. • Press the Home button. • Do nothing for at least 20 seconds.

When the volume bar appears, the feature has been programmed and the PVS screen returns to normal viewing mode.

6. To confirm that this feature is correctly enabled, unplug the headphones for 30–60 seconds, then plug them in. The specified channel should appear for the specified time frame and then the home channel appears.

If the desired sequence happens, then this feature is configured properly. However, if this sequence does not happen, repeat these steps to configure it correctly.

Master Reset

This feature returns the custom features on the Cardio Theater controller to the factory default values. You might use this feature if you are unsure how the custom features have been programmed.

Important: You must reprogram the controller for the PVS screen whenever you perform a Master Reset. Otherwise, the controller may not correctly operate the PVS screen. Refer to Basic Operation - Master Reset and Controller Programming.

1. Plug in headphones before proceeding to make sure that the screen does not turn off while you are programming.
2. Make sure you are on an analog channel. An "A" will precede the channel number.
3. Simultaneously press and hold both **Volume ▲** and **Channel ▲** buttons until the Mute icon appears (about 3 seconds). The Mute icon, which momentarily appears on the screen, indicates that the PVS screen has entered Legacy programming mode. Audio is muted.

4. Press the **Power** button. The volume bar appears confirming the change.

The PVS screen returns to normal viewing mode. All custom features return to the factory defaults.

Custom Feature	Default
Automatic Power On/Off	Disabled
Home Button	Analog channel 4
Inactivity Timer	Disabled
Closed Caption On/Off	Disabled
Promotional Information Content (PIC)	Disabled

Picture Menu

This section describes the features found in the Picture menu. It allows you to adjust contrast, brightness, and other features to improve the quality of the picture shown on the screen.

Note: While you are in programming mode, if you do not press a button within 15 seconds, the PVS screen exits programming mode and returns to normal viewing mode.

Refer to *On Screen Display Menus* to review how to use the controller buttons.

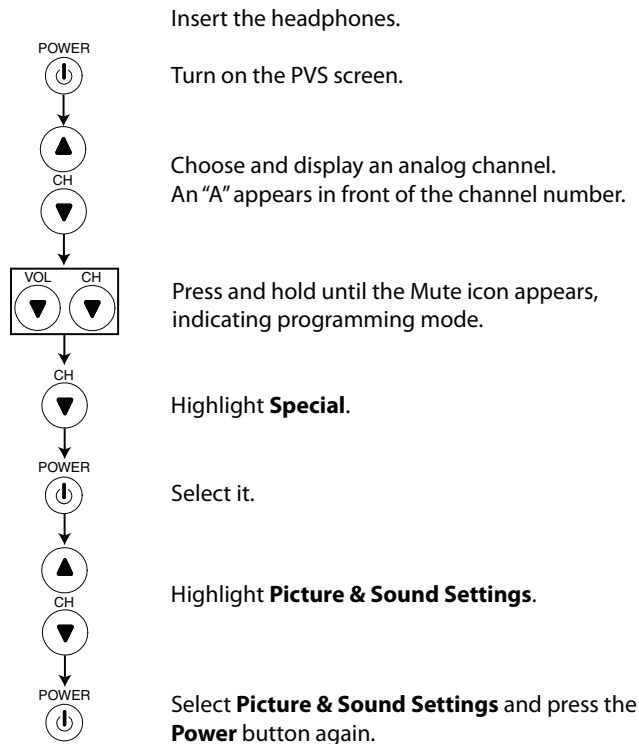

Press the **Mute** button to return to the previous menu level.

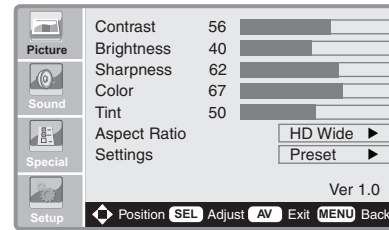

Picture menu

Selected Item	Setting Change
Contrast	More darkness ◀ 0~100 ▶ More light
Brightness	Less bright ◀ 0~100 ▶ More bright
Sharpness	Soft picture ◀ 0~100 ▶ Sharp picture
Color	Lower color intensity ◀ 0~100 ▶ Higher color intensity
Tint	More purple ◀ 0~100 ▶ More green

- HD Wide** When you want to view a picture with HD wide aspect ratio, with black bars appearing at both the top and bottom portions.
- Normal** When you want to view a picture with an original aspect ratio.
- Zoom** When you want to enlarge the picture in correct proportion.

The Settings menu selection lets you quickly reset all the Picture menu options to their original factory values.

Note: Digital picture settings are accomplished in the same manner except you need to choose a digital channel prior to entering the programming mode.

Figure 18: Accessing the Picture menu and its features

Sound Menu

This section describes the features found in the Sound menu. It provides controls for changing the quality of the audio from mono to stereo and resetting the sound features to factory default values.

Note: While you are in programming mode, if you do not press a button within 15 seconds, the PVS screen exits programming mode and returns to normal viewing mode.

Refer to *On Screen Display Menus* to review how to use the controller buttons.

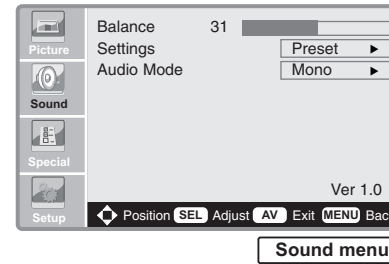
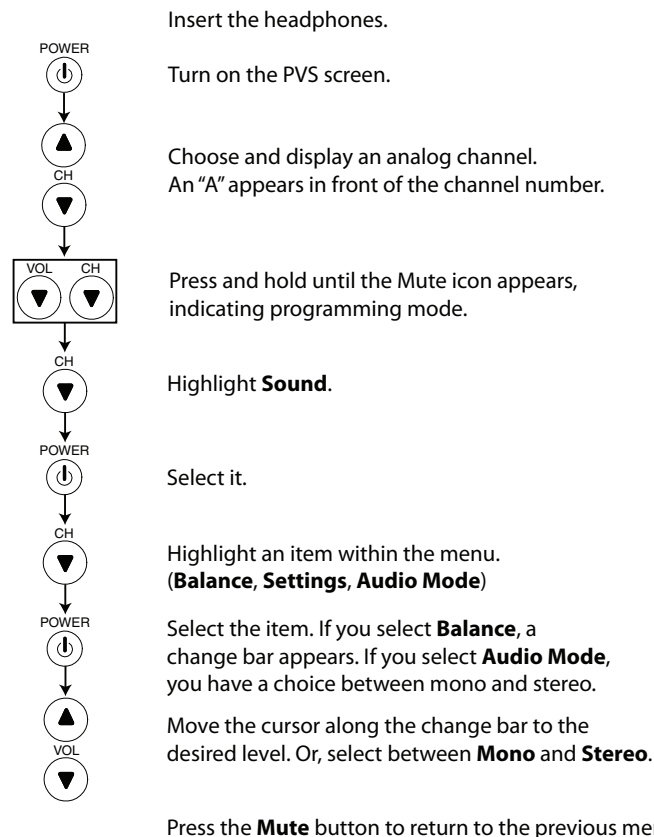

- Mono** Choose Mono for channels broadcasting in mono.
- Stereo** Choose Stereo for channels broadcasting in stereo. If you have difficulty receiving a stereo signal, reset to mono.

The Settings menu selection lets you quickly reset all the Sound menu options to their original factory default values.

Note: Digital audio mode settings are accomplished in the same manner except you need to choose a digital channel prior to entering the programming mode.

Figure 19: Accessing the Sound menu and its features

Special Menu

This section describes the features found in the Special menu.

Note: While you are in programming mode, if you do not press a button within 15 seconds, the PVS screen exits programming mode and returns to normal viewing mode.

Refer to *On Screen Display Menus* to review how to use the controller buttons.

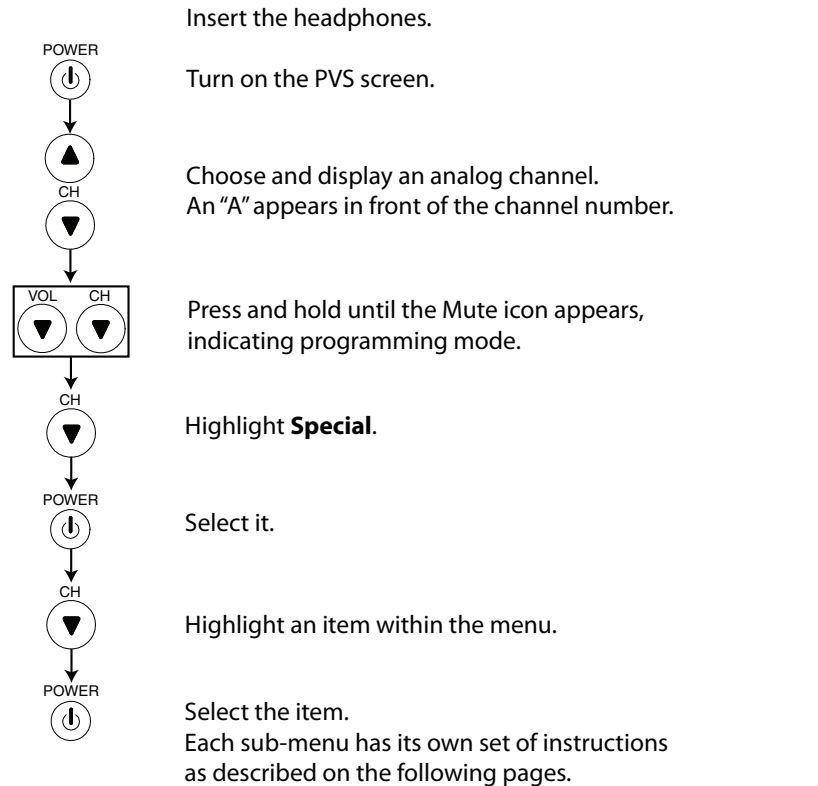

Press the **Mute** button to return to the previous menu level.

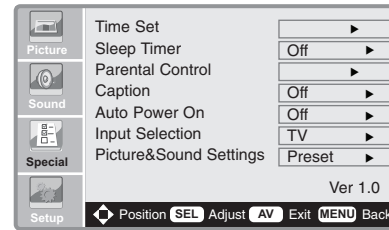

Special menu

Several of the features in the Special menu can only be accessed using the optional remote control. The menu items that you can configure using the Cardio Theater controller include:

Time Set, Sleep Timer, Input Selections and Picture & Sound Settings

The other items, such as Parental Controls, require the optional remote control. Refer to the *Appendix - Optional Remote Control*.

Figure 20: Accessing the Special menu and its features

Manual Time Setting

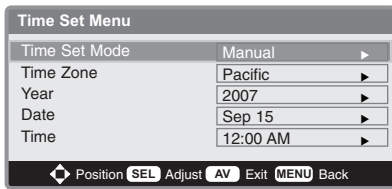
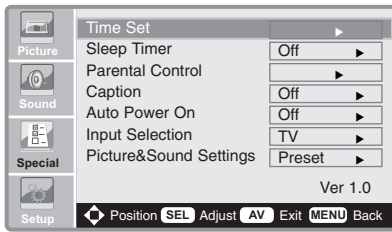

When you choose the **Manual** time mode, you can set the year, date and time. Setting the time is necessary in order to use various timer features on the PVS screen.

Important: If you select the **Auto** time setting, time is set using digital broadcast information and the **Time Set** menu becomes inaccessible.

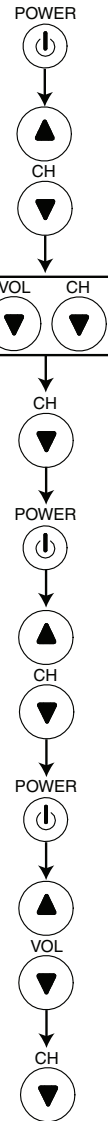

Insert the headphones.

Turn on the PVS screen.

Choose and display an analog channel.
An "A" appears in front of the channel number.

Press and hold until the Mute icon appears, indicating programming mode.

Highlight **Special**.

Select it.

Highlight **Time Set**.

Select **Time Set**.

Select **Manual** in the **Time Set Mode**.

Select the menu item. Use the **Volume** buttons to make any changes. Continue with the same pattern to change the Year, Date, and Time.

Press the **Mute** button to return to the previous menu level.

Figure 21: Accessing the Manual Time Setting menu

Sleep Timer

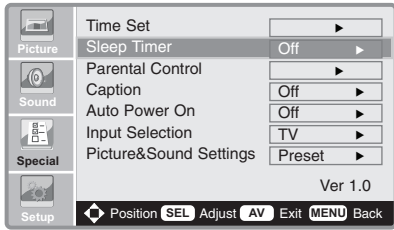

The sleep timer automatically switches the PVS screen to standby after the preset time elapses.

Note: The Cardio Theater integrated controller provides an Inactivity Timer feature which should be used in a fitness facility environment. It provides a preset time before the PVS screen turns off if the headphones are removed. If the custom Inactivity Timer or PIC features are turned on, configuring the Sleep Timer may cause conflicts.

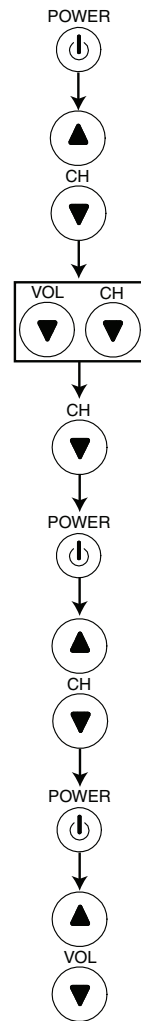

Insert the headphones.

Turn on the PVS screen.

Choose and display an analog channel.
An "A" appears in front of the channel number.

Press and hold until the Mute icon appears, indicating programming mode.

Highlight **Special**.

Select it.

Highlight **Sleep Timer**.

Select **Sleep Timer**.

Select the time limit. Every time you press the **Volume** button, the timer displays the following in sequence:

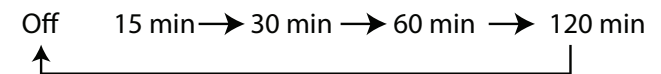

Press the **Mute** button to return to the previous menu level.

Figure 22: Accessing the Sleep Timer settings

Parental Controls

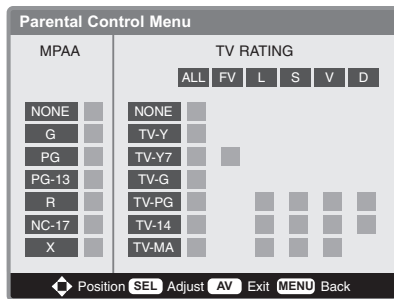
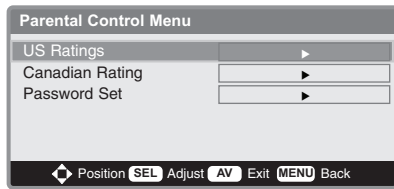
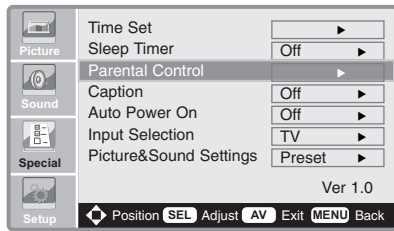

The parental controls can block programs and movies based on their rating. You will need the optional remote control to specify changes to the control menu. The Cardio Theater integrated controller cannot access all the parental control functions. Refer to the *Appendix - Optional Remote Control*.

Caption

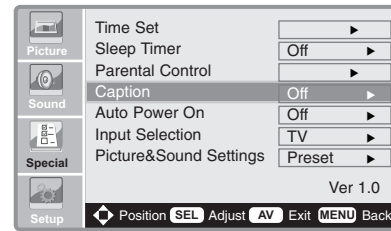

The closed caption feature displays any captioning provided by the TV program. This feature is also part of the integrated controller's custom features. Do not change this setting with the optional remote control if you are using the integrated controller's custom Captioning feature. This menu setting should remain off.

Auto Power On

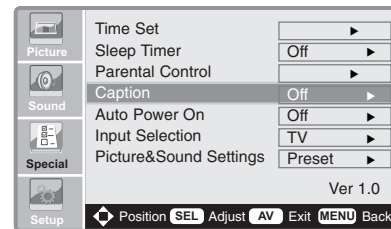

The Auto Power On capability should not be used with the Cardio Theater PVS. Program this feature through the integrated controller's custom programming features. Do not change the setting with the optional remote control. This setting should remain off.

Input Selection

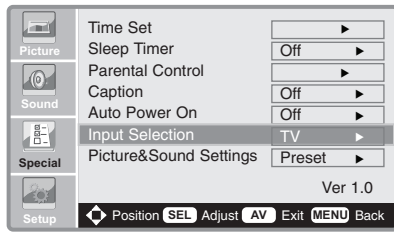

The Input Selection lets you select between TV and Video.

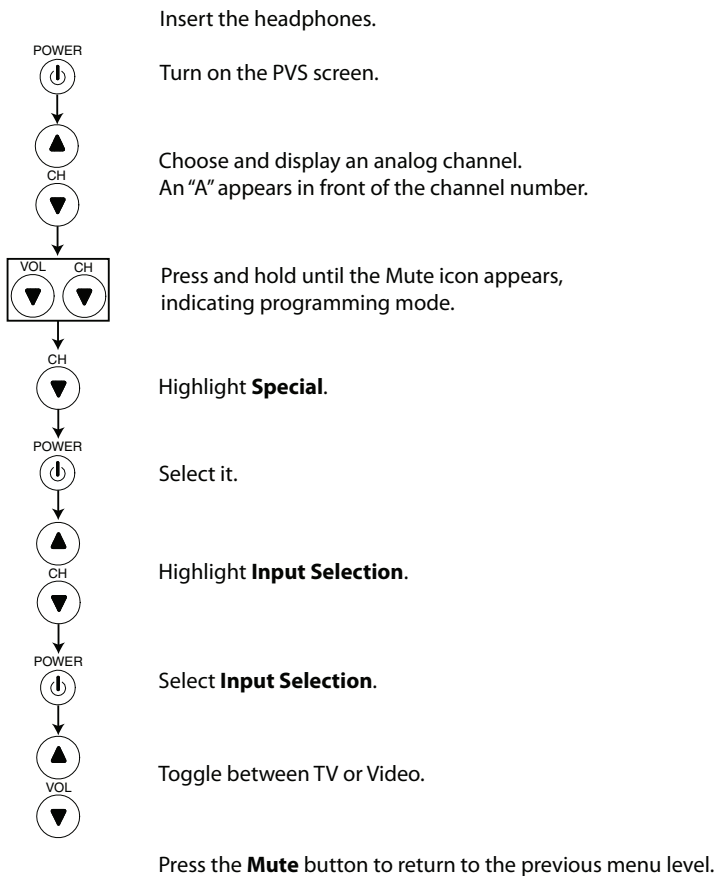
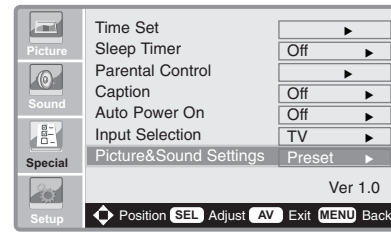

Figure 23: Choosing between TV or Video input

Picture & Sound Settings



This selection lets you quickly reset all the Picture & Sound menu options to their original factory values.

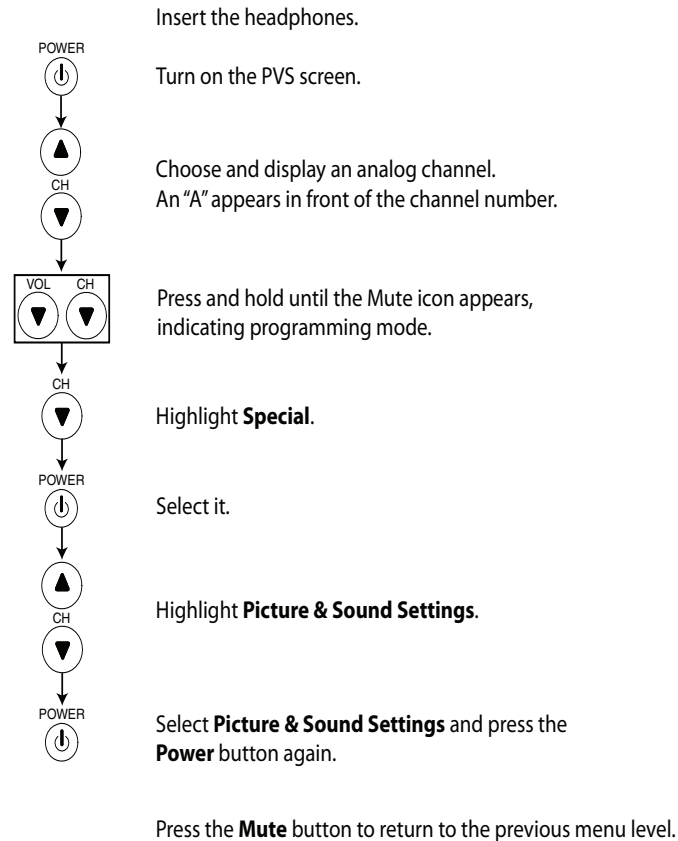

Figure 24: Resetting the Picture and Sound defaults

Using the Optional Personal Entertainment Player

An integrated controller can include the optional Personal Entertainment Player (PEP) feature. This feature allows people to exercise while listening to music or watching video on the PVS screen from their own personal player. A person can even listen to music from their player while watching a regular TV program on the screen, and following that program using Closed Captioning if it is allowed. A person can also turn off the PVS screen and just listen to music from the personal player.

The integrated controller supports most personal video and music players. To watch video, however, the personal player must have the ability to output video through the headphone jack.

Figure 25 gives an overview of the integrated controller with the PEP feature. To use a personal player, a person places the player in the pocket on the integrated controller. A cable in the pocket connects to the headphone jack on the personal player, and allows the music or video to play through the PVS screen and integrated controller. During the exercise session, the personal player will rest safely in the pocket, protected from vibration and movement.

The **Volume** and **Mute** buttons on the integrated controller can be used to change the audio level. Volume can also be modified using the personal player. When volume is modified with a personal player connected, the volume bar does not appear on the screen.

Note: An LED does not appear on the PEP integrated controller. When you are in programming mode, the Mute icon appears briefly on the PVS and the audio is muted.

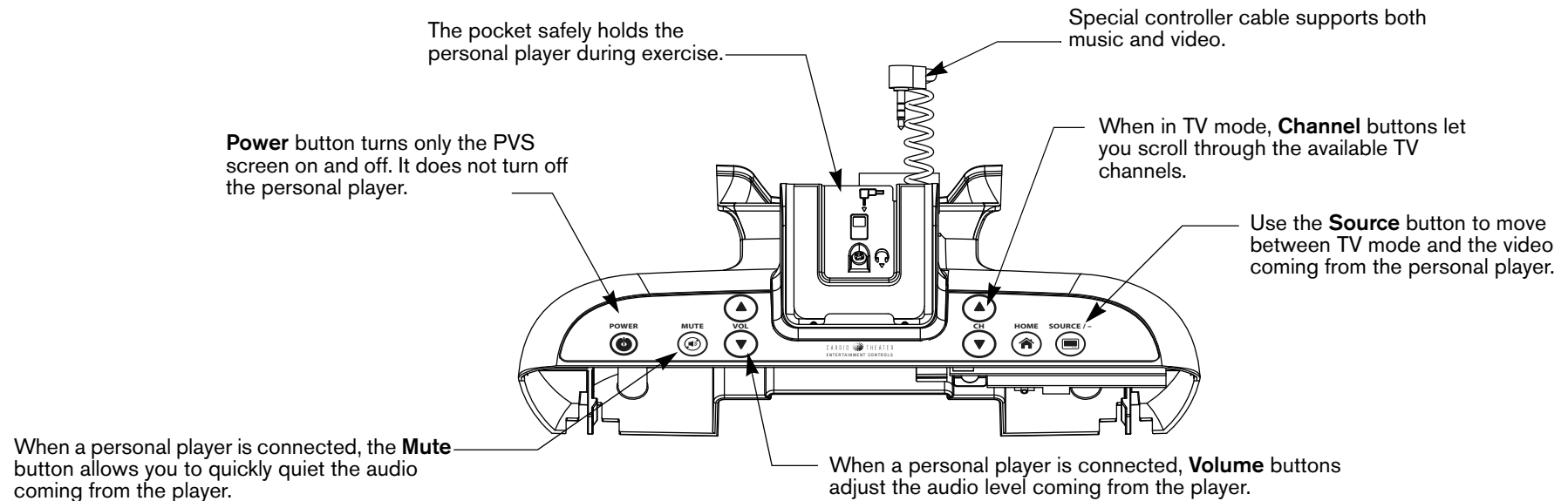

Figure 25: Overview of an integrated controller with the optional PEP feature

How to Use the Personal Player

1. If you plan to watch video, enable the video output on the personal player. If you do not know how to do this, refer to the manual that came with the player.
2. Place the personal player in the pocket on the integrated controller.
3. Plug the controller cable into the headphone jack on the personal player.
4. Plug headphones into the headphone jack on the exercise equipment.
5. Select the music or video you want to play on your player. The video from the personal player is automatically displayed on the PVS screen.
6. If you want to watch TV while listening to music from the player, press **Source** on the integrated controller one or more times to display a TV channel. Use the **Channel** buttons to scroll through the available channels.

Note: To return to the video coming from the personal player, press **Source** again until the video appears on the PVS screen.

Maintenance and Troubleshooting

In general, the PVS screen and integrated controller require little maintenance and will rarely experience problems once installed. However, you may find the information in this section useful.

The integrated controller is designed to handle use by many people in a fitness facility. However, in the unusual event that the integrated controller needs to be replaced, you may need to program the controller so it supports your PVS screen. This section explains how to program the controller for different PVS screens.

This section also explains how to replace the headphone jack when it no longer provides good audio quality.

Cleaning the PVS and Controller

For the Precor exercise equipment, follow the daily cleaning instructions and cautionary statements found in the *Product Owner's Manual*.

Periodically dust the PVS screen with a soft clean cloth.

CAUTION: Do not use liquid cleaners or aerosol cleaners to clean the screen. Do not use any solvents such as alcohol and paint thinner, or acidic cleaners.

Each week, clean the integrated controller with a mild soap and water solution. Lightly dampen a soft clean cloth with the solution and wipe the controller. Do not use too much solution on the cloth or spray cleaning solution directly on controllers. Doing so could cause moisture to enter through the connector and damage the controller.

Replacing the Headphone Jack

When someone experiences no audio or poor audio quality (such as intermittent audio or crackling), you should check the headphone jack. The headphone jack is designed to be easily and quickly replaced at the facility. Make sure you have a new headphone jack (CX30315) before you begin.

1. Firmly grasp the headphone jack, located under the display console. With one hand squeeze the sides near the top while pulling down with your thumb using your other hand. See Figure 26. You may find it helpful to wiggle the jack from side to side. The headphone jack should pop off the display console, with the audio cable still connected.

The headphone jack has two tabs on each side and one tab in the back. These tabs help to secure the headphone jack to the console.

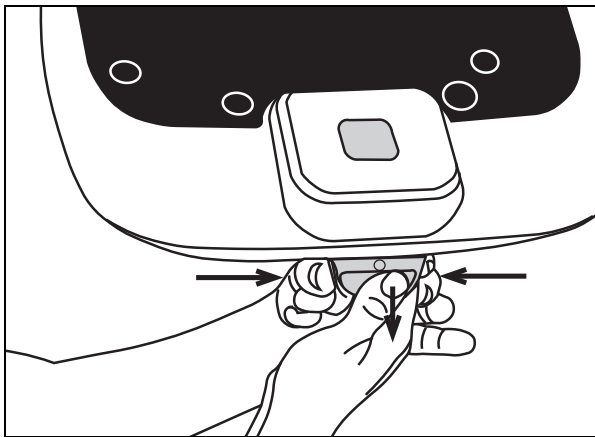

Figure 26: Grasp the headphone jack and remove it from the console

2. Disconnect the audio cable. You can discard the used headphone jack.
3. Slide the stereo plug on the audio cable into the new headphone jack.
4. Replace the headphone jack into place under the display console. Line up the back tab with the back slot, feed the audio cable inside the console, and then snap the two side tabs into the two side slots.

Important: Do not stretch, crimp, or damage the cable. Cables damaged by improper installation will not be covered by the Limited Warranty.

Troubleshooting the PVS

2 may help you to understand and troubleshoot any problems that you encounter with the PVS screen and integrated controller. If the suggestions in the table do not help you solve the problems that you encounter, please contact Cardio Theater Technical Support.

Table 2: How to solve most problems

<i>Issue</i>	<i>What to Do</i>
No power	Make sure the LED is lit on the non-PEP controller. If Automatic Power On/Off feature is enabled, connect headphones to the jack.
No Closed Captioning	Make sure Caption is On under the Caption feature in the Special menu. Closed Captioning may not be available on that channel; try a different channel.
Closed Captioning is delayed	A delay between captioning and the actual dialogue is common in live broadcasts.
Closed Captioning is garbled	Reception is weak or poor signal strength, which is causing problems with the text display. Try a new channel. Make sure cable is securely connected to its connector on the back of the PVS.
No picture	Make sure the PVS screen is fully plugged into a power outlet. Push the Power button. Try a new channel; it may be station trouble. Turn the PVS screen off, and then turn it back on after one minute.
Poor picture	Adjust controls such as Brightness, Color, and Sharpness under the Picture menu.
No audio	Increase the audio level with the Volume ▲ button. Check the headphone jack. Replace the headphone jack if necessary. Make sure you are not in programming mode.
Poor audio	Re-insert the plug into the headphone jack. Try moving the plug in the jack to see if the sound improves. Replace the headphone jack if necessary.

<i>Issue</i>	<i>What to Do</i>
Bars on screen	Try a new channel; it may be station trouble. Make sure video cable is connected to the connector on the back of the PVS. Check for local interference.
Poor TV reception	Adjust Sharpness under the Picture menu. Try a new channel; it may be station trouble. Make sure coaxial cable is securely connected to its connector on the back of the PVS screen. Check for local interference.
Ghosts in picture	Try a new channel; it may be station trouble. Make sure coaxial cable is securely connected to its connector on the back of the PVS screen. Check for local interference.
TV program cannot be watched	Select the channel using the 0–9 keys on the display console. If necessary, rerun the Auto Channel Search feature using the integrated controller (see <i>Initial Search for Channels - Setup Menu.</i>)

Appendix - Optional Remote Control

The optional remote control (also known as the Infrared controller) is provided for maintenance purposes only. The transmission signal from the Infrared controller programs the PVS screen similar to the integrated controller, but the integrated controller provides additional customization as discussed in *Using the Controller to Set Up Custom Features*.

The buttons on the Infrared controller are different than those on the integrated controller. The Infrared controller buttons are documented here. If you plan to use the Infrared controller, you will need to associate the instructions in this manual with the buttons on the Infrared controller.

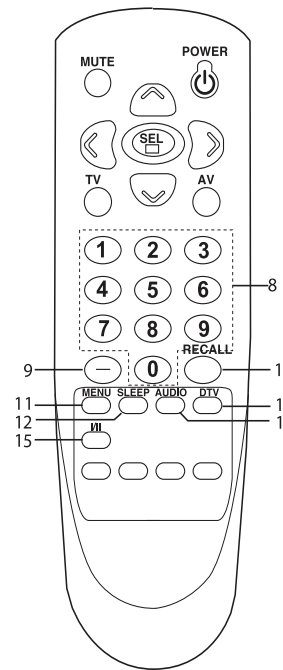
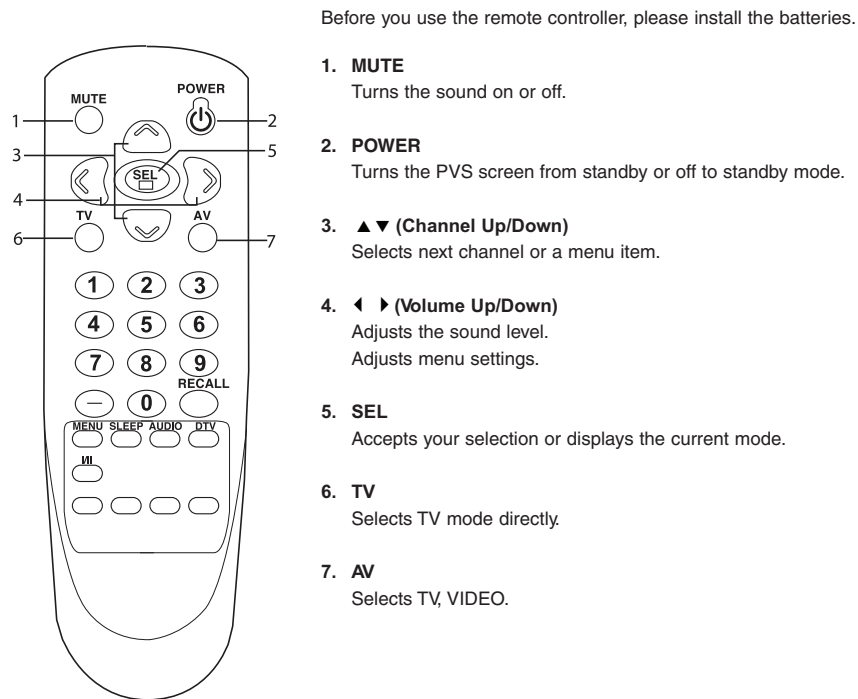

Figure 27: Optional Remote Control (Infrared Controller)

Limited Warranty

PLEASE READ THESE WARRANTY TERMS AND CONDITIONS CAREFULLY BEFORE USING YOUR CARDIO THEATER PRODUCT. BY USING THE EQUIPMENT, YOU ARE CONSENTING TO BE BOUND BY THE FOLLOWING WARRANTY TERMS AND CONDITIONS.

Limited Warranty.

Precor Incorporated ("Precor") warrants all new Cardio Theater products to be free from defects in materials and manufacture for the warranty periods set forth below. The warranty periods commence on the invoice date of the original purchase. This warranty applies only against defects discovered within the warranty period and extends only to the original purchaser of the product. Parts repaired or replaced under the terms of this warranty will be warranted for the remainder of the original warranty period only. To claim under this warranty, the buyer must notify Precor or your authorized Cardio Theater dealer within 30 days after the date of discovery of any nonconformity and make the affected product available for inspection by Precor or its service representative. Cardio Theater product deemed defective by a Cardio Theater representative, will be issued a return authorization number. **Precor will not accept returns without a return authorization number.** Precor reserves the right, at their option, to repair or replace the product after verification of defect. Product that fails after the warranty period expires will be repaired or replaced at the current part and labor pricing after authorization from the customer. Repairs are warranted for 90 days.

Precor's obligations under this warranty are limited as set forth below.

Warranty Periods and Coverage.

• Cardio Theater Transmitters <i>xTV-T Wireless or Wired Floor Models xTVFM system transmitter</i>	3 Years	Parts & Labor
• Cardio Theater Receivers <i>XTV-R Wireless or Wired Upper Models XTVFM system receiver</i>	1 Year	Parts & Labor
• Cardio Theater LCD Screen (PVS)	1 Year	Parts & Labor
• Cardio Theater Screen Controllers	1 Year	Parts & Labor
• Quick Change Headphone Jack	90 Day	Parts Only
• Optional DVD Player	1 Year	Parts
• CT Experience Series Screen (PVS12)	2 Years	Parts & Labor
• CT Experience Series Screen Controller	2 Years	Parts & Labor
• CT Experience Series 900 & 863 Receiver	2 Years	Parts & Labor
• CT Experience Series Quick Change Headphone Jack	90 Days	Parts Only

Conditions and Restrictions.

This warranty is valid only in accordance with the conditions set forth below:

1. The warranty applies to the Cardio Theater product only while
 - a. it remains in the possession of the original purchaser and proof of purchase is demonstrated,
 - b. it has not been subjected to accident, misuse, abuse, improper service, or mechanical, electrical or non-Precor modification.
 - c. claims are made within the warranty period.
2. This warranty does not cover damage or product failure caused by electrical wiring not in compliance with electrical codes or Precor owner's manual specifications, or failure to provide reasonable and necessary maintenance as outlined in the owner's manual. **This warranty excludes misuse or failures of, for example, poor quality CD's, multiple discs inserted in the player, failures caused by home-produced copies of discs, etc.**
3. Except in Canada, Precor does not pay labor outside the United States.
4. Warranties outside the United States and Canada may vary. Please contact your local Dealer for details.

This Limited Warranty shall not apply to:

1. Software (PROM) version upgrades.
2. Normal wear and tear, consumables and cosmetic items, including, but not limited to the following: labels.
3. Repairs performed on Cardio Theater products missing a serial number or with a serial tag that has been altered or defaced.
4. Service calls to correct installation of the product or instruct owners on how to use the product.
5. Pickup and delivery involved with repairs.
6. Any labor costs incurred beyond the applicable labor warranty period.
7. The user is cautioned that changes or modifications not expressly approved by the manufacturer of the product could void the user's authority to operate the product.

Disclaimer and Release.

The warranties provided herein are the exclusive warranties given by Precor and supersede any prior, contrary or additional representations, whether oral or written. ANY IMPLIED WARRANTIES, INCLUDING THE WARRANTY OF MERCHANTABILITY OR FITNESS FOR A PARTICULAR PURPOSE THAT APPLY TO ANY PARTS DESCRIBED ABOVE ARE LIMITED IN DURATION TO THE PERIODS OF EXPRESS WARRANTIES GIVEN ABOVE FOR THOSE SAME PARTS. PRECOR HEREBY DISCLAIMS AND EXCLUDES THOSE WARRANTIES THEREAFTER. Some States do not allow limitations on how long an implied warranty lasts, so the above limitation may not apply to you. PRECOR ALSO HEREBY DISCLAIMS AND EXCLUDES ALL OTHER OBLIGATIONS OR LIABILITIES, EXPRESS OR IMPLIED, ARISING BY LAW OR OTHERWISE, WITH RESPECT TO ANY NONCONFORMANCE OR DEFECT IN ANY PRODUCT, INCLUDING BUT NOT LIMITED TO: (A) ANY OBLIGATION, LIABILITY, RIGHT, CLAIM OR REMEDY IN TORT, WHETHER OR NOT ARISING FROM THE NEGLIGENCE OF PRECOR OR ITS SUPPLIERS (WHETHER ACTIVE, PASSIVE OR IMPUTED); AND (B) ANY OBLIGATION, LIABILITY, RIGHT, CLAIM OR REMEDY FOR LOSS OF OR DAMAGE TO ANY PRODUCT. This disclaimer and release shall apply even if the express warranty set forth above fails of its essential purpose.

Exclusive Remedies.

For any product described above that fails to conform to its warranty, Precor will provide, at their option, one of the following: (1) repair; (2) replacement; or (3) refund of the purchase price. Limited Warranty service may be obtained by contacting the authorized dealer from whom you purchased the item. Precor compensates Servicicers for warranty trips within their normal service area to repair commercial product at the customer's location. You may be charged a trip charge outside the service area. THESE SHALL BE THE SOLE AND EXCLUSIVE REMEDIES OF THE BUYER FOR ANY BREACH OF WARRANTY.

EXCLUSION OF CONSEQUENTIAL AND INCIDENTAL DAMAGES.

PRECOR AND/OR ITS SUPPLIERS SHALL HAVE NO OBLIGATION OR LIABILITY, WHETHER ARISING IN CONTRACT (INCLUDING WARRANTY), TORT (INCLUDING ACTIVE, PASSIVE, OR IMPUTED NEGLIGENCE AND STRICT LIABILITY), OR OTHERWISE, FOR DAMAGE TO THE PRODUCT, PROPERTY DAMAGE, LOSS OF USE, REVENUE OR PROFIT, COST OF CAPITAL, COST OF SUBSTITUTE PRODUCT, ADDITIONAL COSTS INCURRED BY BUYER (BY WAY OF CORRECTION OR OTHERWISE) OR ANY OTHER INCIDENTAL, SPECIAL, INDIRECT, OR CONSEQUENTIAL DAMAGES, WHETHER RESULTING FROM NONDELIVERY OR FROM THE USE, MISUSE OR INABILITY TO USE THE PRODUCT. This exclusion applies even if the above warranty fails of its essential purposes and regardless of whether such damages are sought for breach of warranty, breach of contract, negligence, or strict liability in tort or under any other legal theory. Some states do not allow the exclusion or limitation of incidental or consequential damages, so the above limitation may not apply to you. This warranty gives you specific legal rights, and you may also have other rights, which vary from state to state.

Complete this portion and keep for your records.

Purchased From: _____
(Dealer or store name)

Phone Number: _____
(Dealer or store telephone number)

Product/Model: _____
(For example: Transmitters, Receivers)

Serial Number: _____
(The serial number is found on the shipping container or item.)

Effective 30 June 2006
P/N CX30037-102

Notes:



A Division of Precor Incorporated
20031 142nd Ave NE
Woodinville, WA USA 98072-4002

Cardio Theater, Precor, and EFX are registered trademarks, and Cardio Theater PVS and Cardio Theater Quick Change Headphone Jack are trademarks of Precor Incorporated.
Copyright 2008 Precor Incorporated.
www.cardiotheater.com

NOTICE:

Due to continuing advancements in technology, Precor Incorporated reserves the right to make changes in hardware, packaging, and any accompanying documentation without prior written notice.

PVS12EDTL/CNTE OMG CX30562-101
Warranty Statement CX30037-102
30 June 2008